

**THIS MONTH:** Waterloo Carnival p3 • Bermondsey Carnival p3 • TangoCommuter p5  
Free guided walks p4 • Big Dance at The Scoop p5 • Fun in the Park at Mint Street p3

**July 2008** **10 years**

**in SE1**

**Issue 121** **FREE**

**STEEL & SHAMASH**  
THE WATERLOO COMMUNITY SOLICITORS

*We can help with all your legal problems*

- Property ■ Family ■ Children
- Housing ■ Criminal

For a friendly professional service  
Only two minutes from Waterloo Station

Contact Steel & Shamash  
12 Baylis Road • Waterloo • London • SE1 7AA  
Tel: 020 7803 3999  
Email: mail@steelandshamash.co.uk

# London Festival of Architecture

The London Festival of Architecture builds on the success of the London Architecture Biennale held in 2006 (remember those sheep being driven across the Millennium Bridge?) with an even bigger programme of events.

The festival started on 20 June and runs until 20 July with the focus turning to each of the festival's five hubs in turn. The Southwark & South Bank Hub will come to the fore between Wednesday 9 and Sunday 13 July with installations, exhibitions, talks, tours, walks, films and performances organised by the Architecture Foundation.

Allies & Morrison architects on Southwark Street are hosting an exhibition called *London South Central: Future Developments in South Bank and Southwark* (page 6) showcasing major projects at Waterloo, Blackfriars Road, London Bridge and Elephant & Castle. An accompanying evening debate on Wednesday 9 July will focus on the future of the Elephant & Castle.

The Southwark Lido (pictured; see page 3) is a temporary installation on a vacant site in Union Street by French collective EXYZT providing a meeting and bathing space. The lido will host a variety of activities in an unusual environment.

The LFA brings together the cultural institutions along the south bank of the Thames for late night openings on the evening of Friday 11 July from The Hayward to the Design Museum (page 3). On the same evening parkour and skater films will be shown in the undercroft of the Queen

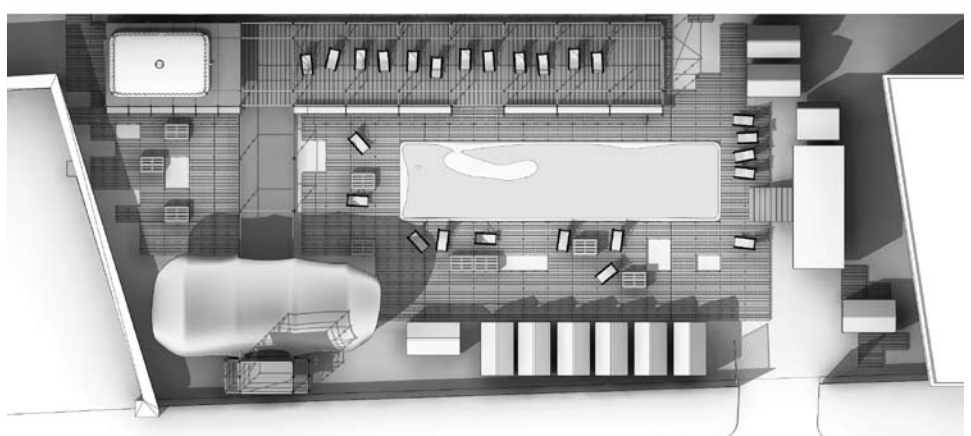

Elizabeth Hall which the Southbank Centre wants to reclaim for a new foyer. More than 4,000 people signed a petition to the Prime Minister calling for the retention of 'Skate City' and Boris Johnson described the potential loss of the skating space as "a great shame".

In Jubilee Gardens former RIBA president Jack Pringle is launching a bid to return the Festival of Britain Skylon to the South Bank (page 7).

The Urban Street Hunt - a photographic treasure hunt - on Saturday 12 July encourages the public to discover hidden spaces around SE1.

Bop to Architecture is a mobile installation coming to Shad Thames (Friday 11), Great Suffolk Street (Saturday 12) and Flat Iron Square (Sunday 13). During the afternoon visitors are invited to enjoy refreshments and listen to of audio samples recorded in Southwark's streets. In the evening the installation becomes a dance floor and party venue.

There is also an installation by artist Scott King on the hoardings at the abandoned 'Tate Tower' building site next to Tate Modern on Hopton Street. With an arresting graphic style King, a former art director at i-D and Sleazemation magazines, plays with the notion of the temporary structure, subverting its original purpose.

Look out for a giant wardrobe by artist Simon Fujiwara under the railway arches at the Union Gallery, Ewer Street (page 7).

The festival includes an extensive programme of bike tours led by architects and experts arranged in association with Southwark Cyclists. The full programme is shown on the website.

• Many London Festival of Architecture events can be found in our listings on pages 3 to 7. A fuller guide and map of the local events is at [www.London-SE1.co.uk/lfa](http://www.London-SE1.co.uk/lfa) or for London-wide listings visit [www.lfa2008.org](http://www.lfa2008.org)

**FRANK HARRIS and Co** (0) 7620 3400 **FRANK HARRIS**

**RESIDENTIAL SALES, LETTINGS and MANAGEMENT**

123 Stamford Street  
London SE1 9NN

**020 7620 3400**  
[www.frankharris.co.uk](http://www.frankharris.co.uk)

**Controlled ZONE W**  
Mon-Fri 8.30 am - 6.30 pm  
Saturday 9.30 am - 1.00 pm

**ARLA**  
Association of Residential Letting Agents

**THE NATIONAL ASSOCIATION OF ESTATE AGENTS**

Looking for a local job?  
Got a local job to advertise?  
[www.London-SE1.co.uk/classifieds](http://www.London-SE1.co.uk/classifieds)

## in SE1

27 Blackfriars Road  
London SE1 8NYTel 020 7633 0766  
Fax 020 7401 2521  
Web www.inSE1.co.uk© 2008 Bankside Press  
ISSN 1750-1334 (Print)  
ISSN 1750-1342 (Online)Editor Leigh Hatts  
Production Editor James Hatts

Contributors Marion Marples

Printed by Copyprints Ltd

## ADVERTISING

For details of our competitive rates call us for a rate card on 020 7633 0766 or email [sales@inSE1.co.uk](mailto:sales@inSE1.co.uk). You can also download our rate card from [www.inSE1.co.uk](http://www.inSE1.co.uk)

## SUBSCRIPTIONS

To receive the next 12 issues by post in the UK please send a cheque for £8 to the address above, made payable to 'in SE1'. Please specify starting issue.

## LISTINGS INFORMATION

Listings for most types of local event are free; details of events to be considered for inclusion next month should be sent by Wednesday 23 July to [se1events@banksidepress.com](mailto:se1events@banksidepress.com) or by post.

## DISCLAIMER

Every effort is made to ensure the accuracy of our listings but all details are subject to alteration by venues and organisers and no responsibility can be accepted for any inaccuracies.

londonSE1  
community websiteWe also publish a community website, updated daily with local news and features and a lively discussion forum. Visit it at [www.London-SE1.co.uk](http://www.London-SE1.co.uk)

## [ SE1 Direct ]

To ensure that you don't miss out on anything that's happening in the area, make sure you receive our weekly email newsletter every Monday. Sign up today by visiting [www.SE1direct.co.uk](http://www.SE1direct.co.uk). With more than 6,300 subscribers, can you afford to miss out?

## In brief

## Free osteopathy for pregnant mothers

On Sunday 13 July the British School of Osteopathy is running a post graduate course for practicing osteopaths. The BSO needs 30-40 pregnant volunteers to be treated for free at the school outpatient clinic as part of this programme. Sessions will be 45 minutes in length throughout the day. To book a free treatment session call 020 7089 5308 or email Nina Waters at [n.waters@bso.ac.uk](mailto:n.waters@bso.ac.uk) quoting EMC/CPD.

## Free junior tennis coaching

Tanner Street Park courts: Free junior tennis coaching Thursdays 5-6pm (10 and under) and 6-7pm (10 and over). Geraldine Mary Harmsworth Park: Free junior tennis coaching on Sunday mornings and Mondays after school. Also adult coaching 5 classes for £40. More hours at GMH and Tanner Street to be confirmed for the summer holidays. Information from [www.southwarkcitytennisclub.org.uk](http://www.southwarkcitytennisclub.org.uk) or email [southwarktennisclub@hotmail.co.uk](mailto:southwarktennisclub@hotmail.co.uk) or head coach Umran Ali on 07736 330542.

## Happy-Go-Lucky

If you missed Mike Leigh's latest film when it was on general release in April you can catch it at BFI Southbank's studio cinema from 25 to 31 July. The opening scenes were shot in Lower Marsh and Crockatt &amp; Powell bookshop also features. Look out for Tower Bridge Primary School and the St John's Estate too. Another Southwark school – Pilgrim's Way off the Old Kent Road – also features. The DVD is out in August.

## West Square event

It's just outside SE1 but worth a mention: West Square (off St George's Road) holds its Annual Garden Event on Saturday 12 July (2pm-4.30pm) with stalls, refreshments and entertainment.

## Quay Players

Local theatre group The Quay Players – based at St Anne's Church Hall in Thorburn Square – are presenting musical romance *Love Off the Shelf* at Dulwich College's Edward Alleyn Theatre on 10, 11 and 12 July. Info: [www.quayplayers.org.uk](http://www.quayplayers.org.uk)

## Reel Lives

A free documentary filmmaking workshop for young people at BFI Southbank 4-8 and 18-22 August. With the help of professional filmmakers learn to plan, shoot and edit a short film. The finished films will be shown at *The Times* BFI London Film Festival. Places must be booked via [alicia.blumross@bfi.org.uk](mailto:alicia.blumross@bfi.org.uk) or 07747 018474 and priority will be given to young people aged 16-19 who live or study in Lambeth or Southwark.

## The Anchor Bankside

The Anchor Bankside pub reopened last month after a £1.6 million refurbishment. New features include a fish &amp; chip shop (cod &amp; chips to eat in or take away £7.99) as well as a tea room named after Samuel Johnson who is known to have frequented the Anchor. Tea for two is £14.95 or a simple cup of tea with a scone is £3.95. There is also a coffee shop on the corner of Bank End and Bankside.

## Museum of Garden History

The Museum of Garden History's stand at the Hampton Court Palace Flower Show this month allows you to peer over the garden fences of two 1970s gardeners. Earlier this year the MGH put out an appeal for 1970s garden tools as it sought to devise a display illustrating the rapid change in garden practice during the decade that the museum was founded. The museum next to Lambeth Palace closes for a major revamp on 4 August and will reopen in the Autumn under the name The Garden Museum.

## Bookcrossing

The Southbank Centre hosts the London Literature Festival from 5 to 19 July. The centre is an international bookcrossing site, encouraging you to share books by leaving them around the site for others to find. This year, hunt down 100 prize-winning paperbacks from the shortlist of *The Best of the Booker Prize*. Catch a new book or release your own. Look out for poet Lemn Sissay reciting from the roof of The Hayward on Saturday 12 July too. Full programme details at [www.londonlitfest.com](http://www.londonlitfest.com)

## CALL in the YARD

Most of the big and successful local firms

do when they have something to say and they would like us to give a sharp edge to it.

PRINT  
COPIES  
REPORTS  
BROCHURESCommunication  
of all kindsCopyprints Ltd  
BUSINESS CENTRE  
1 Talbot Yard  
SE1 1YP[www.copyprintsltd.co.uk](http://www.copyprintsltd.co.uk)Phone 020 7407 2079  
Fax 020 7403 5411

**What's On**  
July  
Comprehensive local listings

**Special events**  
100 Union Street

Wednesday 9 to Sunday 13 July  
**SOUTHWARK LIDO**  
*Wed 7pm-9pm; Thu-Sat 12 noon-9pm;  
Sun 12 noon-7pm; free*  
Temporary bathing and breathing space.  
→ [www.London-SE1.co.uk/e5001](http://www.London-SE1.co.uk/e5001)

**Bernie Spain Gardens**  
Upper Ground  
[www.coinstreet.org](http://www.coinstreet.org)

Sunday 6 July  
**LONDON BOSSA NOVA FESTIVAL**  
*1pm-7pm; free*  
Brazilian music, food and drink.  
→ [www.London-SE1.co.uk/e4657](http://www.London-SE1.co.uk/e4657)

Sunday 20 July  
**COLOMBIANAMENTE**  
*1pm-7pm; free*  
Musicians, actors, circus performers, dancers, marching bands and visual artists plus craft, food and drink stalls bring the sights and sounds of Colombia to SE1.  
→ [www.London-SE1.co.uk/e4929](http://www.London-SE1.co.uk/e4929)

**Bankside 123**  
Canvey Street  
[www.banksidemex.co.uk](http://www.banksidemex.co.uk)

Friday 11 July  
**BANKSIDE 123 STREET PARTY**  
*3pm-8.30pm; free*  
Live music and entertainment to celebrate launch of new shops and restaurants. Also Summer Street, Southwark Street and Great Guildford Street.  
→ [www.London-SE1.co.uk/e5007](http://www.London-SE1.co.uk/e5007)

**La Cave**  
6-10 Borough High Street T 020 7378 0788

Monday 14 July  
**BASTILLE DAY: A TASTE OF FRANCE!**  
*5.30pm-11pm*  
Good food and wine, live music, song and dance. Best attire wins champagne. Free prize draw to win Eurostar tickets.  
→ [www.London-SE1.co.uk/e4951](http://www.London-SE1.co.uk/e4951)

**Coin Street Neighbourhood Centre**  
108 Stamford Street T 020 7021 1600  
[www.coinstreet.org](http://www.coinstreet.org)

Saturday 19 July  
**OPEN DAY**  
*12 noon-5pm; free*  
Afternoon of entertainment and activities.  
→ [www.London-SE1.co.uk/e4685](http://www.London-SE1.co.uk/e4685)

**Design Museum**  
Shad Thames T 0870 909 9009  
[www.designmuseum.org](http://www.designmuseum.org)

Friday 11 July  
**DESIGN OVERTIME: I SPY ... IN THE STREET NIGHT**  
*6pm-10pm; £5*

An after-hours opportunity to see exhibitions including the hit Richard Rogers show. Talks, debates and design workshops.  
→ [www.London-SE1.co.uk/e4803](http://www.London-SE1.co.uk/e4803)

**Downings Roads Moorings**  
Mill Street

Sunday 27 July  
**GARDEN OPEN DAY**  
*2pm-5pm; £3*  
Series of seven floating barge gardens connected by walkways and bridges.  
→ [www.London-SE1.co.uk/e4378](http://www.London-SE1.co.uk/e4378)

**Festival Riverside**  
Belvedere Road

Monday 28 July  
**LIFE'S A BEACH**  
*Festival Beach; 3pm-6pm; free*  
Join conservation experts on the beach below the Royal Festival Hall as they demonstrate the wildlife of the river.  
→ [www.London-SE1.co.uk/e4825](http://www.London-SE1.co.uk/e4825)

**Friars Primary School**  
Webber Street T 020 7207 1807

Saturday 5 July  
**FRIARS SUMMER FAIR**  
*12 noon-3pm; 50p (under-11s free)*  
Stalls, refreshments and activities.  
→ [www.London-SE1.co.uk/e4977](http://www.London-SE1.co.uk/e4977)

**Hay's Galleria**  
Tooley Street

Saturday 12 July  
**LONDON MAGTASTIC**  
*outside Riverside Bookshop; 11am-5pm*  
Celebration of independent magazines presenting unique and quirky perspectives on life in the metropolis. Plus free short walking tours of the area.  
→ [www.London-SE1.co.uk/e4857](http://www.London-SE1.co.uk/e4857)

**The Hayward**  
Belvedere Road T 020 7921 0813  
[www.southbankcentre.co.uk/visualarts](http://www.southbankcentre.co.uk/visualarts)

Friday 11 July  
**40P DAY AT THE HAYWARD**  
*40p*  
40 years to the day since the gallery opened, the £10 admission fee will be reduced to just 40p. See Exhibitions p7.  
→ [www.London-SE1.co.uk/e4246](http://www.London-SE1.co.uk/e4246)

**Jubilee Gardens**  
Belvedere Road

Saturday 19 July  
**INTERNATIONAL BRIGADES COMMEMORATION**  
*1pm*  
Commemoration for the Spanish Civil War republican volunteers from Britain and Ireland. Music, speeches and wreath-laying.  
→ [www.London-SE1.co.uk/e4135](http://www.London-SE1.co.uk/e4135)

**London Glassblowing**  
7 The Leather Market T 020 7403 2800  
[www.londonglassblowing.co.uk](http://www.londonglassblowing.co.uk)

Friday 25 to Sunday 27 July  
**OPEN WEEKEND & SUMMER SALE**  
*11am-5pm*  
Refreshments and demonstrations throughout the day.  
→ [www.London-SE1.co.uk/e4823](http://www.London-SE1.co.uk/e4823)

**London South Bank University**  
[www.lsbu.ac.uk](http://www.lsbu.ac.uk)

Saturday 12 July  
**VILLAGE FETE**  
*Keyworth Street; 12 noon-4pm; free*  
Games and entertainment on Keyworth Street, which will be pedestrianised and transformed with green grass and hay bales. Face painting, craft workshops and friendly farm animals.  
→ [www.London-SE1.co.uk/e4843](http://www.London-SE1.co.uk/e4843)

**Mint Street Park**  
Southwark Bridge Road

Friday 18 July  
**FUN IN THE PARK**  
*3.30pm-9pm; free*  
Fun activities, games, entertainment and information to encourage all to use the park.  
→ [www.London-SE1.co.uk/e4365](http://www.London-SE1.co.uk/e4365)

**National Theatre**  
South Bank T 020 7452 3000  
[www.nationaltheatre.org.uk](http://www.nationaltheatre.org.uk)

Saturday 5 July  
**THE ALTERNATIVE VILLAGE FETE**  
*Theatre Square; 1pm-7.15pm; free*  
Stalls, music, dancing and animals from Vauxhall City Farm. Lower Marsh-based I Knit London will be launching their Great British Sheep project.  
→ [www.London-SE1.co.uk/e4917](http://www.London-SE1.co.uk/e4917)

**Potters Fields Park**  
Tooley Street

Wednesday 30 July to Sunday 3 August  
**MALAYSIA WEEK**  
*10am-6pm; free*  
Music, dance, crafts and cuisine.  
→ [www.London-SE1.co.uk/e4926](http://www.London-SE1.co.uk/e4926)

**River Thames**

Saturday 5 July  
**THAMES BARGE DRIVING RACE**  
*Start Greenwich 12 noon; finish Westminster 2pm onwards*  
Race held annually to demonstrate the traditional skills of the Thames Lightermen.  
→ [www.London-SE1.co.uk/e4662](http://www.London-SE1.co.uk/e4662)

Tuesday 22 July  
**DOGGETT'S COAT & BADGE RACE**  
*1pm at London Bridge*  
Scullers' river race from London Bridge to Chelsea first contested in 1715.  
→ [www.London-SE1.co.uk/e4645](http://www.London-SE1.co.uk/e4645)

**Rose Theatre Exhibition**  
56 Park Street  
[www.rosetheatre.org.uk](http://www.rosetheatre.org.uk)

Saturday 12 & Sunday 13 July  
Saturday 19 & Sunday 20 July  
**NATIONAL ARCHAEOLOGY WEEK**  
*11am-6pm*  
Visit the site of Bankside's first playhouse. Each day at 5pm there will be a talk by Simon Blatherwick, the archaeologist who helped unearth the Rose in 1989.  
→ [www.London-SE1.co.uk/e4546](http://www.London-SE1.co.uk/e4546)

**Royal Festival Hall**  
Belvedere Road T 0871 663 2501  
[www.southbankcentre.co.uk](http://www.southbankcentre.co.uk)

Friday 11 July  
**CAPITAL AGE FESTIVAL**  
*1pm-5pm; free*

Festival open to all celebrates the often forgotten contribution older Londoners make to the capital. Music and dance.  
→ [www.London-SE1.co.uk/e4934](http://www.London-SE1.co.uk/e4934)

**Siobhan Davies Studios**  
85 St George's Road  
[www.siobhandavies.com](http://www.siobhandavies.com)

Saturday 19 July  
**OPEN AFTERNOON**  
*2pm-4pm; free*  
Explore this award-winning building.  
→ [www.London-SE1.co.uk/e4344](http://www.London-SE1.co.uk/e4344)

**Southbank Centre Square**  
Belvedere Road  
[www.southbankcentre.co.uk](http://www.southbankcentre.co.uk)

Until Saturday 5 July  
**LIFT FESTIVAL**  
The Lift hosts inspiring performances, exhibitions, workshops, debates and screenings from 10.15am every morning. The free workshops include t'ai chi and singing with Southbank Centre artist in residence and vocalist Mary King.  
→ [www.London-SE1.co.uk/e4690](http://www.London-SE1.co.uk/e4690)

**Southwark Playhouse**  
Shipwright Yard T 0844 847 1656  
[www.southwarkplayhouse.co.uk](http://www.southwarkplayhouse.co.uk)

Saturday evenings & Tuesday lunchtimes  
**SOUTHWARK PLAYHOUSE SECRETS**  
*Thu 1.15pm; Sat 10.30pm; £6*  
The Playhouse is launching a new series of lunchtime and late-night events including theatre, comedy, storytelling and live art. Full programme at [www.spsecrets.co.uk](http://www.spsecrets.co.uk)  
→ [www.London-SE1.co.uk/v36](http://www.London-SE1.co.uk/v36)

**Spa Gardens**  
Grange Road

Saturday 12 July  
**BERMONDSEY CARNIVAL**  
*12 noon; free*  
Parade through the streets of Bermondsey to Southwark Park for The Event.  
→ [www.London-SE1.co.uk/e4649](http://www.London-SE1.co.uk/e4649)

**St Anne's Bermondsey**  
Thorburn Square T 020 7237 3950  
[www.stannesbermondsey.org.uk](http://www.stannesbermondsey.org.uk)

Saturday 19 July  
**SUMMER FAYRE**  
*2pm-4pm.*  
→ [www.London-SE1.co.uk/e4785](http://www.London-SE1.co.uk/e4785)

**St John's Waterloo**  
Waterloo Road T 020 7633 9819  
[www.stjohnswaterloo.co.uk](http://www.stjohnswaterloo.co.uk)

Sunday 27 July  
**COMMUNITY DAY**  
*12 noon-4pm; free*  
Games, stalls and music in churchyard.  
→ [www.London-SE1.co.uk/e4620](http://www.London-SE1.co.uk/e4620)

**Waterloo Millennium Green**  
[www.waterloocarnival.org.uk](http://www.waterloocarnival.org.uk)

Friday 11 July  
**WATERLOO CARNIVAL**  
*12 noon-11pm; free*  
Annual carnival procession and party in Waterloo. Wizard of Oz theme.  
→ [www.London-SE1.co.uk/e4017](http://www.London-SE1.co.uk/e4017)

**SOUTHWARK ARTS FORUM NEWS**

**Great Value Desk Spaces available at Southwark Arts Forum offices!**

SAF is the Creative Networking organisation for the Arts and Culture in Southwark. We are a membership organisation - anyone is welcome to join for free! Our members include artists and arts/ cultural organisations across all artforms, plus organisations from the education, community, statutory and businesses sector.

[www.southwarkartsforum.org](http://www.southwarkartsforum.org)

- Available NOW!
- Located on Peckham High Street near Peckham Rye and Queen's Road stations
- Free Wi-Fi
- Access to Meeting Room and Kitchen
- Electricity and water included
- General cleaning once a week
- You get a desk, a chair and a filing cabinet
- Photocopier and fax machine available in house
- The desk is in an open plan office shared with other community/arts organisations, small Creative Industries and SMEs
- The price is £175 per month only / one month's deposit
- Contact Ioanna at [ioanna@southwarkartsforum.org](mailto:ioanna@southwarkartsforum.org) / 020 7252 8672 to arrange a viewing now!

## Children &amp; family

## BFI Southbank

Belvedere Road T 020 7928 3535  
www.bfi.org.uk/southbank

**Sunday 27 July**  
**FILM FUNDAY: FLASH GORDON**

Workshop 11.30am; screening 2pm;  
Normal ticket prices  
Screening in NFT1 preceded by workshop  
in foyers (free for ticket-holders).  
→ [www.London-SE1.co.uk/e4907](http://www.London-SE1.co.uk/e4907)

## Design Museum

Shad Thames T 0870 909 9009  
www.designmuseum.org

**Sundays 6, 13, 20 & 27 July**  
**GO ARCHITECTS!**

2pm-5pm; £4 per child; accompanying  
adults £8.50  
Children design and make fantasy  
buildings and structures. Ages 5 to 11.  
→ [www.London-SE1.co.uk/e4885](http://www.London-SE1.co.uk/e4885)

## Florence Nightingale Museum

St Thomas' Hospital T 020 7620 0374  
www.florence-nightingale.co.uk

**Saturday 5 July**  
**HAPPY BIRTHDAY NHS! DOCTORS  
AND NURSES BEFORE THE NHS**

10am-4pm; £5.80, conc £4.80, Family £16  
To celebrate the 60th birthday of the  
NHS, step back in time and meet a  
surgeon from the 1700s.  
→ [www.London-SE1.co.uk/e4755](http://www.London-SE1.co.uk/e4755)

## HMS Belfast

Morgans Lane, Tooley Street T 020 7940 6300  
hmsbelfast.iwm.org.uk

**Saturday 26 to Sunday 27 July**  
**A VIEW FROM THE BRIDGE WEEKEND**

11am-1pm & 2pm-4pm; free  
Hands-on, creative activity from the ship's  
flag deck for under-12s.  
→ [www.London-SE1.co.uk/e4352](http://www.London-SE1.co.uk/e4352)

## Siobhan Davies Studios

85 St George's Road  
www.siobhandavies.com

**Saturday 12 July**  
**PRIMUM BANK BIG DANCE**

90-minute tours & workshops  
11am-12.30pm & 2pm-3.30pm; booking  
essential on 020 7091 9650; free  
Pupils from Charlotte Sharman Primary  
School have been involved in an  
extraordinary dance project investigating  
Siobhan Davies' method of choreography.  
The year 5 children invite you to see their  
work as part of Big Dance 2008.  
→ [www.London-SE1.co.uk/e4342](http://www.London-SE1.co.uk/e4342)

**Saturday 19 July**  
**SMALL DESIGNS**

10am-12.30pm; £4 per child;  
accompanying adults free; booking 020  
7091 9650  
Explore this award-winning building in a  
morning of fun and creative activities for  
all the family. For ages 6 to 10.  
→ [www.London-SE1.co.uk/e4343](http://www.London-SE1.co.uk/e4343)

## Public meetings

## The Community Space

Bankside 3, Great Guildford Street (Zoar St)

**Wednesday 16 July**  
**BANKSIDE RESIDENTS' FORUM AGM**  
 6.30pm

All local residents welcome. Native Land  
gives an update on the Project Bankside  
development in Holland Street. Launch  
of shopping survey to find out where  
you can buy locally at a fair price.  
→ [www.London-SE1.co.uk/e4919](http://www.London-SE1.co.uk/e4919)

## St George the Martyr

Borough High Street

**Tuesday 8 July**  
**BOROUGH & BANKSIDE  
COMMUNITY COUNCIL**

7pm  
For Cathedrals and Chaucer wards. News  
of Cleaner, Greener, Safer projects and  
Community Council Fund grants.  
→ [www.London-SE1.co.uk/e4631](http://www.London-SE1.co.uk/e4631)

## Waterloo Action Centre

14 Baylis Road T 020 7261 1404  
www.waterlooactioncentre.co.uk

**Tuesday 1 July**  
**LET'S USE OUR FREEDOM PASSES**  
*Association of Waterloo Groups office;*  
 2.30pm

Get-together for those interested in  
planning outings using Freedom Passes.  
→ [www.London-SE1.co.uk/e4908](http://www.London-SE1.co.uk/e4908)

**Wednesday 9 July**  
**WATERLOO COMMUNITY  
DEVELOPMENT GROUP**

7pm  
Presentations on Partnership House hotel  
plans and Emma Cons Gardens revamp.  
→ [www.London-SE1.co.uk/e3722](http://www.London-SE1.co.uk/e3722)

## Talks &amp; lectures

## 56 Southwark Bridge Road

**Saturday 12 July**  
**TOUR & TALK**

3pm-5pm; free tickets from 020 7403  
2889 or [eleni.germanou@architype.co.uk](mailto:eleni.germanou@architype.co.uk)  
Architect Ben Humphries leads a tour  
and talk about Architype's new creative  
media training centre in this former  
public library (latterly the Borough  
Community Centre).  
→ [www.London-SE1.co.uk/e4938](http://www.London-SE1.co.uk/e4938)

## Allies and Morrison

85 Southwark Street  
www.alliesandmorrison.co.uk

**Wednesday 9 July**  
**FRESH OR DEATH: THE ELEPHANT  
AND CASTLE DEBATE**

6.30pm; £5 from [www.lfa2008.org](http://www.lfa2008.org)  
Are the Elephant's fortunes finally  
looking up? Panelists include Paul Finch  
(Architectural Review - Chair), Sarah  
Gaventa (CABE), Nigel Hugill (Lend  
Lease), Rowan Moore (Architecture  
Foundation), Tony Travers (London School  
of Economics), Jon Abbott (Southwark  
Council), Richard Powell (First Base) and  
Jennifer Ross (Tibbalds Planning and  
Urban Design).  
→ [www.London-SE1.co.uk/e5003](http://www.London-SE1.co.uk/e5003)

## Coin Street Neighbourhood Centre

108 Stamford Street T 020 7021 1600  
www.coinstreet.org

**Friday 11 July**  
**HOW FOOD HAS SHAPED LONDON**

7pm-9pm; £10 from [www.lfa2008.org](http://www.lfa2008.org)  
Cities, like people, are what they eat.  
The gargantuan effort necessary to feed  
them arguably has a greater social and  
physical impact on us and our planet  
than anything else we do - yet few of us  
are aware of the process.  
→ [www.London-SE1.co.uk/e4742](http://www.London-SE1.co.uk/e4742)

## Design Museum

Shad Thames T 0870 909 9009  
www.designmuseum.org

**Friday 11 July**  
**THE SHAPE OF THINGS TO COME:  
LONDON ARCHITECTURE DEBATE**

7.15pm; £15  
Ricky Burdett leads a discussion.  
→ [www.London-SE1.co.uk/e4933](http://www.London-SE1.co.uk/e4933)

## Fashion &amp; Textile Museum

83 Bermondsey Street T 020 7407 8664  
www.ftmlondon.org

**Wednesday 9 July**  
**AMANDA WAKELEY**

6.30pm-8pm; £10 (conc £7)  
Amanda discusses her work and career  
with FTM curator Dennis Nothdruff.  
→ [www.London-SE1.co.uk/e4936](http://www.London-SE1.co.uk/e4936)

**Wednesday 23 July**  
**REINTERPRETING THE LITTLE BLACK  
DRESS**

6.30pm-8pm; £10 (conc £7)  
Osman Yousefzada with Erin Mullaney  
→ [www.London-SE1.co.uk/e4937](http://www.London-SE1.co.uk/e4937)

## Imperial War Museum

Lambeth Road T 020 7416 5000  
london.iwm.org.uk

**Saturday 26 July**  
**BEFORE WAR AND WINDRUSH**

Conference Room; 1pm; free  
Discussion of black people living and  
working in the UK before the First  
World War as well as class structures and  
diversity across the Caribbean.  
→ [www.London-SE1.co.uk/e4850](http://www.London-SE1.co.uk/e4850)

## Southwark Cathedral

London Bridge T 020 7367 6700  
www.southwark.anglican.org/cathedral/

**Tuesday 8 July**  
**DEFINE YOUR CITY: THE  
ARCHITECTURAL CHARACTERS OF  
LONDON**

6.30pm; free  
Six young architects including Patrick  
Lynch, Liza Fior, Sam Jacob, Jamie Fobert  
and Deborah Saunt.  
→ [www.London-SE1.co.uk/e500](http://www.London-SE1.co.uk/e500)

## Guided walks

## Borough Market

8 Southwark Street

**Friday 11 July**  
**BOROUGH MARKET TOUR**

Meet at Roast; 10.30am-11.30am; free  
Led by Ken Greig and Nigel Stephenson  
of Greig and Stephenson Architects.  
→ [www.London-SE1.co.uk/e5005](http://www.London-SE1.co.uk/e5005)

## Borough Underground Station

Borough High Street

**Mondays 7, 14, 21 & 28 July**  
**EXPLORE NEW SOUTHWARK 2**

2pm; £5 (approx 90 mins)  
Learn about new developments in  
Southwark with architect Paul Taylor.  
→ [www.London-SE1.co.uk/e4820](http://www.London-SE1.co.uk/e4820)

## London Bridge Station

**Wednesday 30 July**  
**BERMONDSEY'S BLITZ WALK**

7.15pm for 7.30pm; £1.50  
Led by Neil Bright. Meet at Tooley Street  
exit near the London Dungeon.  
→ [www.London-SE1.co.uk/e4787](http://www.London-SE1.co.uk/e4787)

## Metropolitan Tabernacle

Elephant & Castle T 020 7735 7076

**Saturday 12 July**  
**THE WALWORTH WALK**

2.15pm; free  
Stroll around Walworth Rd with John Constable.  
→ [www.London-SE1.co.uk/e4745](http://www.London-SE1.co.uk/e4745)

**Sunday 13 July**  
**THE LITTLE TRAMP**

2.15pm; free  
Charlie Chaplin's Elephant and Castle.  
Free guided walk with John Constable.  
→ [www.London-SE1.co.uk/e4746](http://www.London-SE1.co.uk/e4746)

## Southwark Cathedral

London Bridge T 020 7367 6700  
www.southwark.anglican.org/cathedral/

**Friday 18 July**  
**TOUR GUIDING FESTIVAL**

11am-4pm; free  
Free walks delivered by Greenwich  
Community College tour guiding students.  
→ [www.London-SE1.co.uk/e4944](http://www.London-SE1.co.uk/e4944)

## The Community Space

Bankside 3, Great Guildford Street

**Friday 4 July**  
**STREET ART AT TATE MODERN**

5pm-7pm; free  
Walk led by curator Cedar Lewisohn.  
→ [www.London-SE1.co.uk/e4988](http://www.London-SE1.co.uk/e4988)

**Friday 11 July**  
**SECRET BANKSIDE**

5pm-7pm; free  
Walk led by John Constable.  
→ [www.London-SE1.co.uk/e4989](http://www.London-SE1.co.uk/e4989)

**Friday 18 July**  
**A LIVING COMMUNITY**

4.30pm; free  
Learn about the area between Bankside  
and the Elephant & Castle. Ends at the  
Fun in the Park event at Mint Street Park.  
→ [www.London-SE1.co.uk/e4990](http://www.London-SE1.co.uk/e4990)

**Friday 25 July**  
**THAMESSIDE PUBS OF BANKSIDE**

5pm-7pm; free  
Led by Giles Semper. Ends at Boro tube.  
→ [www.London-SE1.co.uk/e4991](http://www.London-SE1.co.uk/e4991)

## Vinopolis

1 Bank End T 020 7940 8300

**Saturday 12 July**  
**SHAKESPEARE'S BANKSIDE**

Meet outside Vinopolis 10.45am; free  
Led by John Constable.  
→ [www.London-SE1.co.uk/e4743](http://www.London-SE1.co.uk/e4743)

**Sunday 13 July**  
**THE DICKENS**

Meet outside Vinopolis 10.45am; free  
Charles Dickens' childhood in The  
Borough. Led by John Constable.  
→ [www.London-SE1.co.uk/e4744](http://www.London-SE1.co.uk/e4744)

## Comedy

## Belushi's

161 Borough High Street T 020 7939 9700

**Tuesday 1 July**  
**EDINBURGH PREVIEW**

8.30pm; £6  
Stephen K Amos and Pappy's Fun Club.  
→ [www.London-SE1.co.uk/e4699](http://www.London-SE1.co.uk/e4699)

**Tuesday 8 July**  
**EDINBURGH PREVIEW**

8.30pm; £6  
The Gently Progressive Behemoth and  
Josie Long.  
→ [www.London-SE1.co.uk/e4700](http://www.London-SE1.co.uk/e4700)

**Tuesday 15 July**  
**EDINBURGH PREVIEW**

8.30pm; £6  
Alexis Dubus and Simon Munnelly.  
→ [www.London-SE1.co.uk/e4701](http://www.London-SE1.co.uk/e4701)

**Tuesday 22 July**  
**EDINBURGH PREVIEW**

8.30pm; £6  
Steve Hall and Reginald D Hunter.  
→ [www.London-SE1.co.uk/e4702](http://www.London-SE1.co.uk/e4702)

## Borough Bar

10 London Bridge Street T 020 7407 6962

**Wednesday 2 July**  
**SUMMER COMIC SHOW SPECIAL**

8pm (doors 6.30pm); £8.50 from 020  
7407 6962  
MC Tim Clarke. Felix Dexter headlines  
this bill. Nick Doody opens the show with  
a 40 minute set. Plus Henry Parker.  
→ [www.London-SE1.co.uk/e4905](http://www.London-SE1.co.uk/e4905)

## Southwark Playhouse

Shipwright Yard T 0844 847 1656  
www.southwarkplayhouse.co.uk

**Sunday 6 July**  
**RICHARD HERRING, ROSIE  
WILKINSON & HELEN O'BRIEN**

8pm; £10  
→ [www.London-SE1.co.uk/e4863](http://www.London-SE1.co.uk/e4863)

# Blackfriars

## Wine Bar

The South Bank's best kept secret invites  
you to discover the charm of an *authentic*  
WINE BAR

We have an extensive range of over 100  
different wines from the Old and New World

Lunches Monday to Friday

Evening meals Tuesday to Friday

Open 10am till late Monday to Friday

ARCH 80, SCORESBY STREET, SOUTHWARK  
LONDON SE1 TEL: 020 7928 0905

3 mins from Southwark station • 5 mins from Tate Modern

Music

**Christ Church Southwark**  
27 Blackfriars Road T 020 7928 4707  
www.christchurchsouthwark.org.uk

Monday 28 July  
**LUNCHTIME CONCERT**  
1.10pm-1.50pm; free  
Suzette Noseda, Peter Nobes and Judith Rust (voice and piano).  
→ www.London-SE1.co.uk/e4054

**Morley College**  
61 Westminster Bridge Road T 020 7928 8501  
www.morleycollege.ac.uk

Tuesday 1 July  
**LUNCHTIME CONCERT**  
1.05pm-1.50pm; free  
Works by Barber, Bernstein, Sondheim and Errollyn Wallen.  
→ www.London-SE1.co.uk/e4617

Tuesday 8 July  
**LUNCHTIME CONCERT**  
1.05pm-1.50pm; free  
Ian Watson and Julie North on accordion.  
→ www.London-SE1.co.uk/e4618

**Museum of Garden History**  
Lambeth Palace Road T 020 7401 8865  
www.museumofgardenhistory.org

Monday 14 July  
**PLEASURES OF VAUXHALL: MUSIC FOR A SUMMER'S EVENING**  
7.30pm; £20 (conc £15) from 020 7401 8865  
18th and 19th century music composed for London's pleasure gardens.  
→ www.London-SE1.co.uk/e4861

**Pizza Express London Bridge**  
4 Borough High Street T 020 7407 2995  
www.pizzaexpress.co.uk

Wednesday 23 July  
**THE BARRETT'S: BANKSIDE NIGHTS**  
5.30pm-8.30pm; free  
Gypsy jazz duo guitarists.  
→ www.London-SE1.co.uk/e4995

**Southwark Cathedral**  
London Bridge T 020 7367 6700  
www.southwark.anglican.org/cathedral/

Mondays 7, 14, 21 & 28 July  
**ORGAN RECITAL**  
1.10pm; free  
Mon 7: Greg Morris  
Mon 14: Peter Wright  
Mon 21: Siu-Wai Ng  
Mon 28: Travis Baker  
→ www.London-SE1.co.uk/e4457

Thursday 10 July  
**VESPERS: WHEN NIGHT FALLS**  
7.30pm; £10-£25 from tickets@londonoriana.com  
Rachmaninoff Vespers. London Oriana Choir.  
→ www.London-SE1.co.uk/e4454

**St John's Waterloo**  
Waterloo Road T 020 7633 9819  
www.stjohnswaterloo.co.uk

Thursdays 3, 10 & 17 July  
**RUSH HOUR CONCERT**  
6pm-7.15pm; free  
Enjoy great music and a glass of wine at these free concerts performed by young musicians from Southbank Sinfonia.  
→ www.London-SE1.co.uk/e4839

Saturday 5 July  
**WESTMINSTER PHILHARMONIC ORCHESTRA**  
7.30pm; £12 (conc £8) or £10 (conc £7) in advance from 020 8607 9450  
Maurice Ravel: La Valse  
Michael Berkeley: Oboe Concerto  
R Vaughan Williams: A London Symphony  
→ www.London-SE1.co.uk/e3769

**The Scoop**  
More London Riverside  
www.morelondon.com/scoop.html

Every Wednesday, Thursday & Friday  
**FREE MUSIC**  
12.30pm & 6.30pm; free  
Full programme of free outdoor music. The full line up is on our website.  
→ www.London-SE1.co.uk/v28

**Vinopolis**  
1 Bank End T 020 7940 8300  
www.vinopolis.co.uk

Wednesday 2 July  
**ZENA JAMES: BANKSIDE NIGHTS**  
Bar Blue; 5.30pm-8.30pm; free  
Featuring Rob Taggart (keyboard) and Paul Morgan (double bass). With her distinctive soulful and bluesy approach to popular standards and lesser-known jazz gems, British vocalist Zena James has received top reviews.  
→ www.London-SE1.co.uk/e4992

Wednesday 9 July  
**TANGENT EYE: BANKSIDE NIGHTS**  
Brew Wharf; 5.30pm-8.30pm; free  
Tangent Eye combines funk, jazz, rock, reggae and more.  
→ www.London-SE1.co.uk/e4993

**Viva Verdi**  
6 Canvey Street T 020 7928 6867  
www.vivaverdiwinebar.com

Wednesday 16 July  
**LIVE OPERA: BANKSIDE NIGHTS**  
5.30pm-8.30pm; free  
An evening of live opera with Julien Debreuil, Demeiza Stafford and Tyler Clarke.  
→ www.London-SE1.co.uk/e4994

**Zakudia**  
2a Southwark Bridge Road T 020 7021 0085

Wednesday 30 July  
**ORLANDO RINCON: BANKSIDE NIGHTS**  
5.30pm-8.30pm; free  
Bolero to Merengue to Salsa to Latin Pop ...  
→ www.London-SE1.co.uk/e4996

**Church services**  
**Southwark Cathedral**  
London Bridge T 020 7367 6700  
www.southwark.anglican.org/cathedral/

Monday 14 July  
**JOHN GOWER CHORAL EVENSONG**  
5.30pm  
Special service to mark the 600th anniversary of the death of John Gower. Prayers will be said at Gower's tomb in the nave of the Cathedral. The service will be followed by readings of work by Gower, and others, in the presence of Andrew Motion, Poet Laureate, and Monty Python's Terry Jones.  
→ www.London-SE1.co.uk/e3824

Dance

**Bridges & Railway Stations**  
Monday 7 July  
**TANGOCOMMUTE**  
6pm-7pm; free

Participatory dance event which will attract hundreds of dancers onto seven Thames bridges and into railway stations including Waterloo and London Bridge. TangoCommute is accessible to everybody and brings the the spirit of compassion and connection between two people as expressed in tango to thousands of commuters during the rush hour.  
→ www.London-SE1.co.uk/e4946

**County Hall**  
Riverside Building, County Hall, Belvedere Road  
www.londoncountyhall.com

Sunday 6 July  
**SCULPTURE IN MOTION**  
County Hall Terrace; 2pm, 4pm, 6pm; free

The Dance, the bronze sculpture on the South Bank by Nasser Azam, has inspired a newly devised piece of contemporary dance to be performed on the County Hall terrace behind the sculpture.  
→ www.London-SE1.co.uk/e4924

**The Scoop**  
More London Riverside  
www.morelondon.com/scoop.html

Saturday 5 July  
**LONDON YOUTH DANCE DAY**  
10am-6pm; free  
Performances by 40+ young companies.  
→ www.London-SE1.co.uk/e4923

Sunday 6 July  
**BIG DANCE DROP**  
8.30am-6pm; free  
Outdoor performances and workshops in street dance and hip hop.  
→ www.London-SE1.co.uk/e4922

Monday 7 July  
**SOUTHWARK'S A-Z OF DANCE**  
12 noon-6pm; free  
Acts range from the traditional, ballet, modern and tap to the innovative 'Belly-Bolly-Banghra' and the hair-raising Scissors Dance.  
→ www.London-SE1.co.uk/e4484

Tuesday 8 July  
**ROCK CHALLENGE**  
11am-4pm; free  
Break the record for leading the biggest dance class at 1pm.  
→ www.London-SE1.co.uk/e4860

Wednesday 9 July  
**THE BIG DANCE - SALSA DAY**  
12.30pm; free  
Salsa warm up demonstration and dance workshop ready for evening event.  
→ www.London-SE1.co.uk/e4726

Wednesday 9 July  
**WORLD CHAMPION DEMONSTRATION & CONJUNTO SABROSO**  
6.30pm; free  
Demonstration by John Vasquez and Judy Aguilar from Cali in Columbia; the current salsa dance world champions.  
→ www.London-SE1.co.uk/e4727

Thursday 10 July  
**SING IT TO THE RHYTHM WORKSHOP**  
12.30pm; free  
Antonio Susinni leads a dance workshop focusing on Calypso, Mento and other folk music from the USA and Caribbean.  
→ www.London-SE1.co.uk/e4728

**Unicorn Theatre**  
147 Tooley Street T 020 7645 0560  
www.unicorntheatre.com

Friday 18 to Saturday 19 July  
**BALLET CENTRAL**  
Fri 2pm; Sat 7.30pm; £15 (conc £10)  
Come and see the dance stars of tomorrow, today. For ages 6+  
→ www.London-SE1.co.uk/e4767

**Theatre**  
**Menier Chocolate Factory**  
51 Southwark Street T 020 7907 7060  
www.menierchocolatefactory.com

Until Sunday 20 July  
**THE COMMON PURSUIT**  
Tue-Sat 8pm; Sat & Sun 3.30pm; £22.50  
Sharp comedy by Simon Gray. With James Dreyfus and Nigel Harman.  
→ www.London-SE1.co.uk/e4551

Friday 25 July to Sunday 28 September  
**THEY'RE PLAYING OUR SONG**  
Tue-Sat 8pm; Sat & Sun 3.30pm; £25 (conc & previews £20)  
Semi-autobiographical story based on the relationship between composer Marvin Hamlisch and lyricist Carole Bayer Sager. With Connie Fisher and Alistair McGowan.  
→ www.London-SE1.co.uk/e4928

**National Theatre**  
South Bank T 020 7452 3000  
www.nationaltheatre.org.uk

Until Thursday 7 August  
**THE REVENGER'S TRAGEDY**  
Oliver Theatre; In repertory; £10; £15; £30  
Tickets: www.inSE1.co.uk/tickets/4475  
Thomas Middleton's ferociously dark play.  
→ www.London-SE1.co.uk/e4475

Until Saturday 9 August  
**HARPER REGAN**  
Cottesloe Theatre; In repertory; £10-£29  
A new play by Simon Stephens directed by Marianne Elliott.  
→ www.London-SE1.co.uk/e3919

Thursday 24 July to Saturday 9 August  
**HER NAKED SKIN**  
Olivier Theatre; In repertory; TBC  
A new play by Rebecca Lenkiewicz.  
→ www.London-SE1.co.uk/e4479

Monday 21 July to Wednesday 13 August  
**A SLIGHT ACHE**  
Lyttelton Theatre; Selected dates 6pm; running time approx 50 mins; £10  
Simon Russell Beale and Clare Higgins play the couple in this early work by Harold Pinter; Iqbal Khan directs.  
→ www.London-SE1.co.uk/e4481

Until Thursday 14 August  
**NEVER SO GOOD**  
Lyttelton Theatre; In repertory; TBC  
By Howard Brenton.  
→ www.London-SE1.co.uk/e4476

**DENTAL PATIENTS**  
**Tower Bridge Dental Surgery**

We are taking on new NHS patients and offering a late night session for fee-paying patients: Thursday 9am - 8pm  
Come in and make a consultation appointment with us.  
We will help you attain the smile you always wanted...  
• Whitening  
• Specialised cleaning techniques  
• Cosmetic treatment  
Call in at 25 Tower Bridge Road  
Tel: 020 7407 7427  
Email annobkw46@aol.com

Looking for a car parking space at a reasonable rate?  
Contact: St Mary's Church  
Kennington Park Road  
Tel 020 7355 1894

**ELECTRICIAN**  
No job too small!  
07850 767283  
glennies@bigfoot.com

**THE TRADITIONAL ACUPUNCTURE CENTRE**  
75 Roupell Street, London SE1 8SS • 020 7928 8333  
acupunctureltd@btconnect.com • www.acupuncturecentre.org.uk

The largest dedicated acupuncture clinic in Europe established since 1983. More than 20 professionally qualified and registered practitioners of Chinese Medicine including Herbal Medicine and Tui Na (Chinese Medical Massage)

5 minute walk from Waterloo, Waterloo East and Southwark stations  
Open 8am-9pm Mondays to Fridays • 9am-6pm Saturdays  
Calm and tranquil atmosphere.

Free consultations to discuss whether treatment could be helpful for you.

Wednesday 23 July to Thursday 14 August  
**...SOME TRACE OF HER**

Cottesloe Theatre; In repertory; TBC  
Inspired by *The Idiot* by Fyodor Dostoevsky and adapted by Katie Mitchell and the company.  
→ [www.London-SE1.co.uk/e4478](http://www.London-SE1.co.uk/e4478)

Until Saturday 16 August

#### AFTERLIFE

Lyttelton Theatre; In repertory; TBC  
A new play by Michael Frayn.  
→ [www.London-SE1.co.uk/e4477](http://www.London-SE1.co.uk/e4477)

Until Wednesday 24 September

#### THE YEAR OF MAGICAL THINKING

Lyttelton Theatre; In repertory; £10-£41  
Adapted from Joan Didion's memoir of the same name.  
→ [www.London-SE1.co.uk/e3918](http://www.London-SE1.co.uk/e3918)

#### Pacific Playhouse

5-6 Playhouse Court, 62 Southwark Bridge Road  
[www.pacificplayhouse.com](http://www.pacificplayhouse.com)

Wednesday 23 to Thursday 24 July

#### PRECIOUS THINGS

7pm; £10 (conc £7)  
A new work from Shaky Isles Theatre directed by Stella Duffy. We want to be good, we want to play - we wonder if the two things can go together.  
→ [www.London-SE1.co.uk/e4984](http://www.London-SE1.co.uk/e4984)

#### Potters Fields Park

Tooley Street

Saturday 19 July

#### UNICORN YOUTH THEATRE

12.30pm & 3pm; free  
Promenade performance created by the young artists as a part of the London-wide Pavilions project (see Exhibitions).  
→ [www.London-SE1.co.uk/e4768](http://www.London-SE1.co.uk/e4768)

#### Shakespeare's Globe

New Globe Walk T 020 7401 9919  
[www.shakespeares-globe.org](http://www.shakespeares-globe.org)

Until Sunday 17 August

#### KING LEAR

In repertory; £5-£33  
Tickets: [www.inSE1.co.uk/tickets/3614](http://www.inSE1.co.uk/tickets/3614)  
Globe artistic director Dominic Dromgoole directs Shakespeare's most profound tragedy.  
→ [www.London-SE1.co.uk/e3614](http://www.London-SE1.co.uk/e3614)

Sunday 6 July to Sunday 17 August

#### THE FRONTLINE

In repertory; £5-£33  
Tickets: [www.inSE1.co.uk/tickets/3620](http://www.inSE1.co.uk/tickets/3620)  
Ché Walker's new play set on a Saturday night outside Camden Town tube. Walker wrote the play between scenes whilst acting in *Othello* at the Globe last summer.  
→ [www.London-SE1.co.uk/e3620](http://www.London-SE1.co.uk/e3620)

Saturday 26 July to Friday 3 October

#### TIMON OF ATHENS

In repertory; £5-£33  
Tickets: [www.inSE1.co.uk/tickets/3621](http://www.inSE1.co.uk/tickets/3621)  
With music by Django Bates.  
→ [www.London-SE1.co.uk/e3621](http://www.London-SE1.co.uk/e3621)

Until Saturday 4 October

#### A MIDSUMMER NIGHT'S DREAM

In repertory; £5-£33  
Tickets: [www.inSE1.co.uk/tickets/3615](http://www.inSE1.co.uk/tickets/3615)  
Directed by Christopher Luscombe.  
→ [www.London-SE1.co.uk/e3618](http://www.London-SE1.co.uk/e3618)

#### Southwark Playhouse

Shipwright Yard T 0844 847 1656  
[www.southwarkplayhouse.co.uk](http://www.southwarkplayhouse.co.uk)

Wednesday 2 to Saturday 12 July

#### UNSTATED: STORIES OF REFUGE

7.30pm (Sat 3pm); £7-£20 (airline-style)  
Based on the testimonies of the men and women who seek refuge in the UK. Part performance, part installation.  
→ [www.London-SE1.co.uk/e4842](http://www.London-SE1.co.uk/e4842)

Monday 14 to Saturday 19 July

#### THE MAGDALENE MYSTERIES

7.30pm; £7-£20 (airline-style)  
A cross-cultural cast of actors, dancers and singers tells the stories of Mary Magdalene through vocal music, contemporary dance and a devised text based on historical documents.  
→ [www.London-SE1.co.uk/e4792](http://www.London-SE1.co.uk/e4792)

Monday 21 July to Saturday 2 August

#### SHAKESPEARE'S R&J

7.30pm; £7-£20 (airline-style)  
By Joe Calarco. Set in the 1950s at a boarding school, four pupils run into the chapel late one night in a bid to escape from their repressive routines. One of them brings a copy of *Romeo and Juliet* and they start acting pieces out.  
→ [www.London-SE1.co.uk/e4847](http://www.London-SE1.co.uk/e4847)

#### The Old Vic

103 The Cut T 0870 060 6628  
[www.oldvictheatre.com](http://www.oldvictheatre.com)

Until Saturday 9 August

#### PYGMALION

Mon-Sat 7.30pm; Wed & Sat 2.30pm; £10-£45  
Tickets: [www.inSE1.co.uk/tickets/3488](http://www.inSE1.co.uk/tickets/3488)  
Peter Hall directs Bernard Shaw's enduring classic. With Tim Pigott-Smith. Run now extended till 9 August.  
→ [www.London-SE1.co.uk/e3488](http://www.London-SE1.co.uk/e3488)

#### The Scoop

More London Riverside  
[www.morelondon.com/scoop.html](http://www.morelondon.com/scoop.html)

Thursday 31 July to Sunday 7 September

#### BLOOD WEDDING

Wed-Sun 8pm; free  
Free open-air production of Lorca's play.  
→ [www.London-SE1.co.uk/e4703](http://www.London-SE1.co.uk/e4703)

#### Unicorn Theatre

147 Tooley Street T 020 7645 0560  
[www.unicorntheatre.com](http://www.unicorntheatre.com)

Wednesday 2 to Sunday 20 July

#### THE WHALE'S TOOTH

Clore Theatre; Times vary; Children £6.50 (companions free)  
Adapted from *The Arctic Fox* by Mary Ellis. Designed for people with severe, profound and multiple learning difficulties or complex physical or medical needs.  
→ [www.London-SE1.co.uk/e3881](http://www.London-SE1.co.uk/e3881)

#### Union Theatre

204 Union Street T 020 7261 9876  
[www.uniontheatre.org](http://www.uniontheatre.org)

Until Saturday 19 July

#### ALL NUILITY SHALL BE PUNISHED

Tue-Sat 7.30pm; £8 (weekends £12)  
Fear and obsession, the pervasive presence of death, sex, money and power reigns in this Nelson Rodrigues play.  
→ [www.London-SE1.co.uk/e4986](http://www.London-SE1.co.uk/e4986)

Wednesday 23 July to Saturday 16 August

#### THE MIKADO

Wed-Sat 7.30pm (matinees Sat & Sun 3pm); £15 (Wed £10)  
Sasha Regan presents an all male cast in *The Mikado* by Gilbert and Sullivan.  
→ [www.London-SE1.co.uk/e4776](http://www.London-SE1.co.uk/e4776)

#### Young Vic

66 The Cut T 020 7928 6363  
[www.youngvic.org](http://www.youngvic.org)

Thursday 17 to Tuesday 22 July

#### STREET SCENE

7.30pm; £22.50 (under-26s £10)  
Musical melting pot of working class New York with music by Kurt Weill.  
→ [www.London-SE1.co.uk/e4566](http://www.London-SE1.co.uk/e4566)

## Movie highlights

#### BFI IMAX

Charlie Chaplin Walk T 0870 787 2525  
[www.bfi.org.uk/imax](http://www.bfi.org.uk/imax)

Saturday 12 July

#### AFTER DARK ALL-NIGHTER: THE X-MEN TRILOGY & MYSTERY MEN

11.30pm; £25 (conc £18)  
Introduced by Sir Ian McKellen. Free tea and coffee between the films with drinks, snacks and sweets on sale.  
→ [www.London-SE1.co.uk/e4987](http://www.London-SE1.co.uk/e4987)

#### BFI Southbank

Belvedere Road T 020 7928 3535  
[www.bfi.org.uk/southbank](http://www.bfi.org.uk/southbank)

Tuesday 15 July

#### KILLER OF SHEEP

2pm; Normal prices; Booking essential on 020 7928 3232  
Screening for local seniors. A rare opportunity to see Charles Burnett's cult classic of 80s black working class culture.  
→ [www.London-SE1.co.uk/e4415](http://www.London-SE1.co.uk/e4415)

Thursday 31 July

#### MY DARLING CLEMENTINE

2pm; Booking essential on 020 7928 3232; free  
Screening for local seniors. John Ford's poetic telling of the Wild West. With Henry Ford, Victor Mature.  
→ [www.London-SE1.co.uk/e4416](http://www.London-SE1.co.uk/e4416)

#### Roxy Bar & Screen

128-132 Borough High Street T 020 7407 4057  
[www.roxybarandscreen.com](http://www.roxybarandscreen.com)

Sunday 27 July

#### AUSTRALIA DAY

2pm-late; free  
Double bill of Aussie thrillers + Q&A  
→ [www.London-SE1.co.uk/e4976](http://www.London-SE1.co.uk/e4976)

#### St Mary's Churchyard

Newington Butts

Saturday 12 July

#### ELEFEST OUTDOOR CINEMA

3pm till late; free  
Outdoor cinema in St Mary's Churchyard with pre-screening DJ and "Knit the Aylesbury" workshops from 1 Knit London and InSPire. 8.30pm *The Elephant Will Never Forget* (1953). 9pm *We Was All One* (1972) Thames Television documentary made as the last of the post war slum clearances were made and Heygate Estate was completed.  
→ [www.London-SE1.co.uk/e5000](http://www.London-SE1.co.uk/e5000)

#### Tate Modern

Bankside T 020 7887 8888  
[www.tate.org.uk/modern](http://www.tate.org.uk/modern)

Monday 14 July

#### COMMUNITY FILM CLUB:

#### THE LAMBETH ESTATE

7pm (refreshments from 6.30pm); free to members  
Jack Thurston's 45-minute 2005 film celebrates the history of Roupell Street, Whittlesey Street, Theed Street, Brad Street and Cornwall Road. Membership of the Community Film Club is primarily aimed at those living and working in Southwark and Lambeth. To become a member email [communityfilmclub@tate.org.uk](mailto:communityfilmclub@tate.org.uk) or join on the night.  
→ [www.London-SE1.co.uk/e4805](http://www.London-SE1.co.uk/e4805)

## Exhibitions

#### Allies and Morrison

85 Southwark Street  
[www.alliesandmorrison.co.uk](http://www.alliesandmorrison.co.uk)

Wednesday 9 to Thursday 20 July

#### LONDON SOUTH CENTRAL

10.30am-6pm; free  
Major projects shaping Waterloo, Blackfriars Road, London Bridge and Elephant & Castle.  
→ [www.London-SE1.co.uk/e4734](http://www.London-SE1.co.uk/e4734)

#### The Art Academy

55 Southwark Street T 020 7401 6539  
[www.artacademy.org.uk](http://www.artacademy.org.uk)

Wednesday 9 to Sunday 13 July

#### GRADUATE SHOW 2008

Wed-Fri 12.30pm-7.30pm; Sat & Sun 11am-5pm; free  
Graduating students from the Academy's unique three-year Diploma course.  
→ [www.London-SE1.co.uk/e4816](http://www.London-SE1.co.uk/e4816)

#### Bankside Gallery

48 Hopton Street T 020 7928 7521  
[www.banksidegallery.com](http://www.banksidegallery.com)  
Daily 11am-6pm; free

Wednesday 2 to Sunday 20 July

#### SEARCHING FOR A BIGGER SUBJECT

British artist Tony Foster makes epic paintings from epic landscapes.  
→ [www.London-SE1.co.uk/e4758](http://www.London-SE1.co.uk/e4758)

Tuesday 22 to Sunday 27 July

#### BOUNDLESS: CONNECTING ARTISTS

Work by twelve learning disabled artists and three professional artists.  
→ [www.London-SE1.co.uk/e4759](http://www.London-SE1.co.uk/e4759)

#### Bankside Pier

Bankside

Until Sunday 20 July

#### DARK WATERS

Audio-visual installation.  
→ [www.London-SE1.co.uk/e4738](http://www.London-SE1.co.uk/e4738)

#### The Bargehouse

Barge House Street T 020 7401 2255  
[www.oxotower.co.uk](http://www.oxotower.co.uk)  
Daily 11am-6pm; free

Friday 11 to Sunday 13 July

#### GOLDSMITHS MA IMAGE AND COMMUNICATIONS DEGREE SHOW

→ [www.London-SE1.co.uk/e4436](http://www.London-SE1.co.uk/e4436)

#### BFI Southbank

Belvedere Road T 020 7928 3535  
[www.bfi.org.uk/southbank](http://www.bfi.org.uk/southbank)  
Gallery Tue-Sat 11am-8pm; free

Until Sunday 31 August

#### FASTER, HIGHER

Audiovisual project by Susan Pui San Lok.  
→ [www.London-SE1.co.uk/e4410](http://www.London-SE1.co.uk/e4410)

#### Design Museum

Shad Thames T 0870 909 9009  
[www.designmuseum.org](http://www.designmuseum.org)  
Daily 10am-5.45pm (last admission 5.15pm); £8.50 (conc £6.50; students £5); Under 12s free

Until Monday 25 August

#### RICHARD ROGERS + ARCHITECTS: FROM THE HOUSE TO THE CITY

Includes unbuilt plans for South Bank.  
→ [www.London-SE1.co.uk/e3756](http://www.London-SE1.co.uk/e3756)

Until Sunday 28 September

#### INDUSTRIAL FACILITY

The everyday and the useful.  
→ [www.London-SE1.co.uk/e4062](http://www.London-SE1.co.uk/e4062)

Until Sunday 28 September

#### TIM WALKER: PICTURES

Fashion photographer.  
→ [www.London-SE1.co.uk/e4063](http://www.London-SE1.co.uk/e4063)

#### f a projects

1-2 Bear Gardens T 020 7928 3228  
[www.faprojects.com](http://www.faprojects.com)  
Tue-Fri 10am-6pm; Sat 12 noon-5pm; free

Friday 4 July to Friday 1 August

#### ANDRÉ TEN BROEKE

First solo exhibition in London.  
→ [www.London-SE1.co.uk/e4939](http://www.London-SE1.co.uk/e4939)

#### Fashion & Textile Museum

83 Bermondsey Street T 020 7407 8664  
[www.ftmlondon.org](http://www.ftmlondon.org)  
Exhibitions Wed-Sun 11am-6pm; £5 (conc £3); under-12s free

**londonSE1**  
community website

**This month's hot topics**

Bike theft in Chaucer Drive  
**Christening gifts**  
Development on Recall site  
**Wind turbines on Colombo House, Blackfriars Road**  
Newington Butts pawn shop  
**Lear at the Globe**  
Tlon Books closed again  
**Zizzi, Shad Thames**  
Shipp's Tearooms  
**Thai Food Ingredients**  
Tooley Street in 1938  
**St Thomas' Street arches**

Tesco Old Kent Road re-development  
**Bermondsey Street Conservation Area**  
Babysitter  
**Elephant & Castle: back to the drawing board?**  
Bermondsey Street tunnel  
**...and dozens more topics**

**Join the debate at**  
[www.London-SE1.co.uk](http://www.London-SE1.co.uk)

Until Monday 25 August  
**LITTLE BLACK DRESS**  
Trends come and go but for over 90 years the Little Black Dress has remained.  
→ [www.London-SE1.co.uk/e4470](http://www.London-SE1.co.uk/e4470)

**Former St Olave's Grammar School**  
Tooley Street

Until Sunday 20 July  
**CO-EVOLUTION**  
9am-5pm; free  
Proposals for sustainable urban development in China.  
→ [www.London-SE1.co.uk/e4945](http://www.London-SE1.co.uk/e4945)

**The Hayward**  
Belvedere Road T 020 7921 0813  
[www.southbankcentre.co.uk/visualarts](http://www.southbankcentre.co.uk/visualarts)  
Daily 10am-6pm (Fri till 10pm)

Until Monday 25 August  
**PSYCHO BUILDINGS**  
£10 (conc available)  
10 artists transform indoor & outdoor spaces.  
→ [www.London-SE1.co.uk/e3575](http://www.London-SE1.co.uk/e3575)

Until Sunday 17 August  
**HYPERBOLIC CROCHET CORAL REEF**  
Project Space; free  
Mutating series of hand-made crochets that replicate the forms of natural coral.  
→ [www.London-SE1.co.uk/e3681](http://www.London-SE1.co.uk/e3681)

**Imperial War Museum**  
Lambeth Road T 020 7416 5000  
[london.iwm.org.uk](http://london.iwm.org.uk)  
Daily 10am-6pm; free

Until Sunday 2 March 2009  
**FOR YOUR EYES ONLY**  
£8 (conc £7; children £4; family £19)  
Life and work of Ian Fleming.  
→ [www.London-SE1.co.uk/e3083](http://www.London-SE1.co.uk/e3083)

Until Sunday 30 March 2009  
**FROM WAR TO WINDRUSH**  
Personal stories of Black men & women.  
→ [www.London-SE1.co.uk/e4332](http://www.London-SE1.co.uk/e4332)

**Jerwood Space**  
171 Union Street T 020 7654 0171  
[www.jerwoodspace.co.uk](http://www.jerwoodspace.co.uk)  
Mon-Fri 10am-5pm; Sat & Sun 10am-3pm; free

Until Sunday 13 July  
**JERWOOD CONTEMPORARY MAKERS**  
Seven British makers on theme of 'touch'.  
→ [www.London-SE1.co.uk/e3648](http://www.London-SE1.co.uk/e3648)

**Jubilee Gardens**  
Belvedere Road

Wednesday 9 to Sunday 13 July  
**SKYLON: LONDON'S LOST ICON**  
Launch of a nationwide campaign to rebuild the Festival of Britain Skylon.  
→ [www.London-SE1.co.uk/e4737](http://www.London-SE1.co.uk/e4737)

**Llewellyn Alexander Fine Paintings**  
124-126 The Cut T 020 7620 1322  
[www.llewellynalexander.com](http://www.llewellynalexander.com)  
Mon-Sat 10am-7.30pm; free

Until Saturday 23 August  
**NOT THE ROYAL ACADEMY**  
A Salon des Refusés.  
→ [www.London-SE1.co.uk/e3762](http://www.London-SE1.co.uk/e3762)

**Menier Gallery**  
51 Southwark Street T 020 7407 3222  
[www.menierchocolatefactory.com/gallery](http://www.menierchocolatefactory.com/gallery)  
Mon-Sat 10am-6pm; free

Tuesday 1 to Saturday 12 July  
**LOOP08**  
14 artists and printmakers.  
→ [www.London-SE1.co.uk/e4280](http://www.London-SE1.co.uk/e4280)

Tuesday 15 to Saturday 19 July  
**ARUNIMA CHOUDHURY**  
First London solo exhibition.  
→ [www.London-SE1.co.uk/e4925](http://www.London-SE1.co.uk/e4925)

Wednesday 23 July to Thursday 14 August  
**IN SEARCH OF BEAUTY & WELLBEING**  
Paintings in Hospitals summer exhibition.  
→ [www.London-SE1.co.uk/e4830](http://www.London-SE1.co.uk/e4830)

**Morley College**  
61 Westminster Bridge Road T 020 7928 8501  
[www.morleycollege.ac.uk](http://www.morleycollege.ac.uk)  
Gallery Mon-Fri 11am-6pm; Thu until 7pm; Sat 12 noon-4pm;

Thursday 17 to Wednesday 23 July  
**ARTY BIRD EXHIBITION**  
End of year exhibition for the artist in residence course.  
→ [www.London-SE1.co.uk/e4849](http://www.London-SE1.co.uk/e4849)

**National Theatre**  
South Bank T 020 7452 3000  
[www.nationaltheatre.org.uk](http://www.nationaltheatre.org.uk)  
Foyers open Mon-Sat 9.30am-11pm; free

Until Sunday 20 July  
**UPSHOT**  
Photographs of hidden spaces at the top of London's highest buildings.  
→ [www.London-SE1.co.uk/e4472](http://www.London-SE1.co.uk/e4472)

Saturday 5 July to Saturday 30 August  
**THE PRESS PHOTOGRAPHER'S YEAR**  
The world seen by UK snappers in 2007.  
→ [www.London-SE1.co.uk/e4473](http://www.London-SE1.co.uk/e4473)

**Nolia's Gallery**  
60 Great Suffolk Street T 020 7701 9111  
[www.noliassgallery.co.uk](http://www.noliassgallery.co.uk)

Tuesday 1 to Wednesday 9 July  
**SS9**  
12 noon-6pm  
Eight artists.  
→ [www.London-SE1.co.uk/e4909](http://www.London-SE1.co.uk/e4909)

Thursday 24 to Tuesday 29 July  
**RED (EMOTIONAL ABSTRACTIONS)**  
1pm-6pm  
Paintings by Tracy Whitbread.  
→ [www.London-SE1.co.uk/e4910](http://www.London-SE1.co.uk/e4910)

**Novas Contemporary Urban Centre**  
73-81 Southwark Bridge Road T 020 7357 6469  
[www.novasscarman.org](http://www.novasscarman.org)  
Mon-Sat 10am-6pm; free

Monday 14 to Sunday 20 July  
**IN THIS PLACE OF SAFETY**  
Multimedia installation on exterior.  
→ [www.London-SE1.co.uk/e4729](http://www.London-SE1.co.uk/e4729)

Until Sunday 20 July  
**SOUNDINGS FROM THE ESTUARY**  
Responding to the Thames Estuary.  
→ [www.London-SE1.co.uk/e4733](http://www.London-SE1.co.uk/e4733)

**Oxo Tower Restaurant**  
Oxo Tower Wharf T 020 7803 3888

Until Tuesday 26 August  
**SOHEILA KEYANI**  
Local Waterloo artist.  
→ [www.London-SE1.co.uk/e4998](http://www.London-SE1.co.uk/e4998)

**Potters Fields Park**  
Tooley Street

Friday 4 to Sunday 20 July  
**POWDER BLUE ORTHOGONAL PAVILION**  
British artist Toby Paterson presents 'Powder Blue Orthogonal Pavilion' in Potters Fields Park as part of Portavilion by UP Projects. Responding to the adjacent architecture of Tower Bridge, City Hall and HMS Belfast, Paterson inserts another strongly graphic form - a wooden, modular structure - into the local "town-scape". A newly choreographed dance performance will take place around Toby Paterson's pavilion on 11 July.  
→ [www.London-SE1.co.uk/e5002](http://www.London-SE1.co.uk/e5002)

**Poussin Gallery**  
K, 175 Bermondsey Street T 020 7403 4444  
[www.poussin-gallery.com](http://www.poussin-gallery.com)  
Wed-Sat 1pm-7pm; free

Thursday 10 July to Saturday 16 August  
**GEOMETRY AND COLOUR**  
The summer show features artists who exploit geometry's basic elements, its points, lines and angles.  
→ [www.London-SE1.co.uk/e4978](http://www.London-SE1.co.uk/e4978)

**Purdy Hicks Gallery**  
65 Hopton Street T 020 7401 9229  
[www.purdyhicks.com](http://www.purdyhicks.com)  
Mon-Fri 10am-5.30pm (wed 7pm); Sat & Sun 12 noon-5pm; free

Until Wednesday 16 July  
**RALPH FLECK**  
Professor Fleck returns with a new show featuring oils of bookshelves and Venice.  
→ [www.London-SE1.co.uk/e4324](http://www.London-SE1.co.uk/e4324)

Wednesday 9 July to Saturday 9 August  
**HELSINKI SCHOOL**  
→ [www.London-SE1.co.uk/e4325](http://www.London-SE1.co.uk/e4325)

**RKB Gallery**  
61 Union Street  
[www.rkburton.co.uk/gallery](http://www.rkburton.co.uk/gallery)

Until Friday 11 July  
**MAIDSTONE COLLEGE**  
Student art show.  
→ [www.London-SE1.co.uk/e4797](http://www.London-SE1.co.uk/e4797)

**SE1 Gallery**  
Upper Studio, 1 Crucifix Lane T 020 7357 8999  
[www.se1gallery.com](http://www.se1gallery.com)  
Thu-Sun 11am-6pm; free

Until Sunday 6 July  
**PAMELA IZZARD**  
New paintings.  
→ [www.London-SE1.co.uk/e4979](http://www.London-SE1.co.uk/e4979)

**Southwark Cathedral**  
London Bridge T 020 7367 6700  
[www.southwark.anglican.org/cathedral/](http://www.southwark.anglican.org/cathedral/)  
Daily 8am-6pm; free

Until Friday 18 July  
**MARGARET MELLOR**  
Eleven collages by Waterloo resident Margaret Mellor on display in Refectory.  
→ [www.London-SE1.co.uk/e4655](http://www.London-SE1.co.uk/e4655)

**Tate Modern**  
Bankside T 020 7887 8888  
[www.tate.org.uk/modern](http://www.tate.org.uk/modern)  
Sun-Thu 10am-6pm; Fri & Sat 10am-10pm; free

Until Tuesday 5 August  
**STREET ART**  
Street artists take over gallery exterior.  
→ [www.London-SE1.co.uk/e4594](http://www.London-SE1.co.uk/e4594)

Until Sunday 31 August  
**STREET & STUDIO**  
£10 (conc £8)  
More than 300 works by 19th & 20th-century photographers.  
→ [www.London-SE1.co.uk/e3312](http://www.London-SE1.co.uk/e3312)

Until Sunday 14 September  
**CY TWOMBLY: CYCLES AND SEASONS**  
£10 (conc £8)  
Coinciding with Twombly's 80th birthday, first major UK retrospective for 20 years.  
→ [www.London-SE1.co.uk/e3188](http://www.London-SE1.co.uk/e3188)

**the.gallery@oxo**  
Oxo Tower Wharf T 020 7401 2255  
[www.coinstreet.org](http://www.coinstreet.org)  
Daily 11am-6pm; free

Until Sunday 6 July  
**EXPOSED: ENDANGERED WILDLIFE**  
Roger Hooper's wildlife photography.  
→ [www.London-SE1.co.uk/e4434](http://www.London-SE1.co.uk/e4434)

Thursday 24 July to Sunday 10 August  
**MIND OVER MATTER: IMAGES OF PINK FLOYD**  
Cover artist Storm Thorgerson.  
→ [www.London-SE1.co.uk/e4435](http://www.London-SE1.co.uk/e4435)

**Tower Bridge Exhibition**  
Tower Bridge T 020 7940 3985  
[www.towerbridge.org.uk](http://www.towerbridge.org.uk)  
10am-5.30pm; £6 (conc £4.50; child £3)

Until Sunday 7 September  
**WHAT THE VICTORIANS DID FOR US**  
Great Victorians and great inventions.  
→ [www.London-SE1.co.uk/e4556](http://www.London-SE1.co.uk/e4556)

**Union Gallery**  
57 Ewer Street T 020 7928 3388  
[www.union-gallery.com](http://www.union-gallery.com)  
Mon-Fri 10am-6pm, Sat 12 noon-5pm; free

Until Saturday 5 July  
**SEA HYUN LEE**  
Constant shuffling of recurring fragments.  
→ [www.London-SE1.co.uk/e4564](http://www.London-SE1.co.uk/e4564)

Wednesday 9 to Sunday 20 July  
**CLOSET GALLERY**  
Cabinet of curiosities by Simon Fujiwara.  
→ [www.London-SE1.co.uk/e4741](http://www.London-SE1.co.uk/e4741)

Wednesday 16 July to Saturday 13 September  
**TONIGHT FORGET ABOUT YOUR HOUSES AND CARS**  
Group summer show on climate change.  
→ [www.London-SE1.co.uk/e4921](http://www.London-SE1.co.uk/e4921)

**Waterloo Arts Gallery**  
14 Baylis Road T 020 7928 2243  
[www.waterloogallery.co.uk](http://www.waterloogallery.co.uk)  
Mon-Sat 11am-6pm; free

Monday 21 to Saturday 26 July  
**MAUREEN OLIVER**  
→ [www.London-SE1.co.uk/e4799](http://www.London-SE1.co.uk/e4799)

Monday 28 July to Saturday 2 August  
**IAN BARRACLOUGH**  
→ [www.London-SE1.co.uk/e4980](http://www.London-SE1.co.uk/e4980)



## Borough & Bankside Community Council

Tuesday 8 July – 7:00pm  
St George the Martyr Church  
Borough High Street, SE1

Have your say at our next meeting where we will be announcing this year's Cleaner, Greener, Safer projects and grants under the Community Council Fund along with updates from police and community wardens and much more...

Visit our website [www.southwark.gov.uk](http://www.southwark.gov.uk) or phone 020 7525 7514



## BOOK REVIEW

# The Greater London History & Heritage Handbook

Peter Marcan Publications • £25

**It is nine years since the last edition of this handbook which was described then as “an indispensable reference tool”.**

This latest version is not just an update but a rewrite. It is extraordinary that almost a decade on this book carries information not easily found, if there at all, on the web.

Those living in SE1 will find questions many would like to ask are answered such as: what is the difference between BRF and BOST? Waterloo residents will at last find an explanation of WCDG and WGT. And what is Better Bankside? Also, if Potters Fields Park is not run by the council how do you contact the park management?

Much of the large paperback, which has around 1,250 entries, is divided into London council areas but the Elephant & Castle has its own dedicated section. Those interested in planning applications will be pleased to find such useful information as contact and membership numbers for the Thorney Island Society which is objecting to proposed South Bank skyscrapers spoiling the view from Westminster.

Advertisements include one for Joy Levine's historic walks and the image library run by Peter Marshall who has recorded many events in Lambeth and Southwark.

The book, illustrated with black and white prints, is available for £25 plus £2.50 postage and packing from Peter Marcan, PO Box 3158, London SE1 4RA. Cheques should be made payable to 'Peter Marcan'.

**Next month • August 2008**

Carnaval del Pueblo procession from Elephant & Castle to Burgess Park • Festa! Brazilian community theatre at the Young Vic • London Poetry Festival • Live Olympic Picture Desk at National Theatre • all that and more in next issue

Local news you may have missed

**LondonSE1**  
community website**Public inquiry into hotel plan for St Olave's School**

The future of the former St Olave's Grammar School is now in the hands of a planning inspector who conducted a two-day public inquiry into Berkeley Homes' proposal to turn the building into a boutique hotel.  
...more at [www.London-SE1.co.uk/n3370](http://www.London-SE1.co.uk/n3370)

**Celebs at Cathedral for Rolling Stone daughter's wedding**

A large crowd watched singer Leah Wood and Jack MacDonald leave Southwark Cathedral after their wedding last month.  
...more at [www.London-SE1.co.uk/n3369](http://www.London-SE1.co.uk/n3369)

**Shipp's Tearooms shut by lease dispute**

Shipp's Tearooms in Park Street has suddenly closed following a request by its landlords.  
...more at [www.London-SE1.co.uk/n3359](http://www.London-SE1.co.uk/n3359)

**Tesco submits plans for Old Kent Road redevelopment**

Tesco has submitted plans to redevelop its site on the Old Kent Road with a larger store and more than 350 new homes.  
...more at [www.London-SE1.co.uk/n3356](http://www.London-SE1.co.uk/n3356)

**Gambling centre approved for Borough High Street**

Proposals for an adult gaming centre in Borough High Street have been approved by Borough & Bankside Community Council - and an application for a second centre on the same street has been submitted.  
...more at [www.London-SE1.co.uk/n3353](http://www.London-SE1.co.uk/n3353)

**Dockhead Fire Station to be rebuilt**

Dockhead Fire Station, which appeared in popular TV drama London's Burning, is to be demolished if a planned private finance initiative scheme goes ahead.  
...more at [www.London-SE1.co.uk/n3349](http://www.London-SE1.co.uk/n3349)

**Russians buy in to Beetham's Blackfriars skyscraper scheme**

Russian firm the Mirax Group has spent £60 million on a 50 per cent stake in the proposed 52-storey Beetham Tower planned for the northern end of Blackfriars Road.  
...more at [www.London-SE1.co.uk/n3343](http://www.London-SE1.co.uk/n3343)

**Denis Norden unveils Elephant Trocadero cinema plaque**

A plaque has been installed at Metro Central Heights on New Kent Road to commemorate the Trocadero and Odeon cinemas which formerly occupied part of the site.  
...more at [www.London-SE1.co.uk/n3339](http://www.London-SE1.co.uk/n3339)

**M&S Simply Food Bankside store draws a crowd**

A new Marks & Spencer food store has opened in Southwark Street to an enthusiastic reception.  
...more at [www.London-SE1.co.uk/n3338](http://www.London-SE1.co.uk/n3338)

**Tony Hart opens Art House at Cathedral School**

Veteran TV artist Tony Hart and young celebrity artist Stephen Wiltshire performed the opening ceremony at Cathedral School's Art House.  
...more at [www.London-SE1.co.uk/n3365](http://www.London-SE1.co.uk/n3365)

**LONDON SOUTH BANK UNIVERSITY**

# The Villagefête

LSBU is bringing the countryside to the inner city!

**Saturday 12 July 12pm - 4pm**

Keyworth Street SE1, Entrance is FREE

Join us for an afternoon of traditional village fête activities and free entertainment with an urban edge.

We're transforming the campus with grass and hay bales and the event will be a unique blend of contemporary world music, traditional activities and games for the whole family.

Why not have a go on our Crazy Bikes, get a henna tattoo or test your skills at the Coconut Shy? There will also be interactive activities, from theatre and craft making workshops to demonstrations. All activities are free to enjoy!

[www.lsbu.ac.uk/villagefete](http://www.lsbu.ac.uk/villagefete)