

# in SE1

Second  
anniversary  
issue

Issue 23

May 2000

Free

# Tate Modern

## Queen to open flagship developments in SE1 this month

It has finally arrived; we can now talk about Tate Modern in the present tense.

The Queen, who in 1963 opened the Bankside Power Station, will return to Bankside on Thursday 11 May to open the Tate Modern within the same landmark building.

The Royal opening is at 11am and will be shown live on BBC1. There will also be live broadcasts in the evening during the opening party which will include a light show on the north side of the building from 9pm. This will best be viewed from the riverside walkway on the City of London bank.

The Tate Modern opens to the public at 10am on Friday 12 May and admission is to be free. Meanwhile the Bankside Residents' Forum and Southwark Council will be monitoring crowd and traffic movements to ensure that disruption is kept to a minimum during the summer months when thousands of visitors are expected.

Bankside residents have already viewed the interior of Tate Modern during a special preview evening last month. Following a visit to the top floor café there was an opportunity to explore the building and enjoy

the unexpected views. The top floor is higher than the original roof which was inspected by some residents when the Tate first acquired the building.

Last minute preparations for completing building and furnishing work include the addition of an illuminated hat on the famous chimney.

The Royal visit to the Tate will come just two days after the Queen is due to officially open the Millennium Bridge. Her Majesty will attend a service at 11am in St Paul's Cathedral on Tuesday 9 May and afterwards make her way to the new bridge. Music is to be provided by students from the Guildhall School of Music and the nearby City of London Boys' School who will be on barges beneath the bridge.

During the ceremony the Bishops of London and Southwark are due to meet on

the bridge to symbolise the close partnership of the two central London dioceses.

Also taking part will be both the Lord Mayor of London and the Mayor of Southwark representing two riverside councils which are working together as part of the Cross River Partnership.

- [www.tate.org.uk/modern](http://www.tate.org.uk/modern)
- We have also launched a set of Tate Modern pages on our website at [www.London-SE1.co.uk/tate](http://www.London-SE1.co.uk/tate) providing links to other Tate-related resources.
- See page 2 for details of the Tate exhibition at RIBA this month
- The Millennium Bridge will open to the public next month, after the HSBC Millennium Bridge Walk in aid of Save the Children on Saturday 10 June. Call 020 7252 4141 to register or visit the website at [www.savethechildren.org.uk/millenniumbridge](http://www.savethechildren.org.uk/millenniumbridge)

Your *in* SE1 continues to expand

Welcome to issue 23 of *in* SE1. Two years have now passed since we produced the first issue and so much has changed in SE1. Not least Tate Modern, which seemed a distant prospect even in 1998, is now a reality. Thank you to our advertisers, subscribers and supporters who have helped us to establish *in* SE1 as the top guide to what's happening in this part of London.

We have introduced a few changes to the listings pages of this issue which we hope will make our guide even easier to use.

*in* SE1 is now available for download in Adobe Acrobat (PDF) format on our website at [www.inSE1.co.uk](http://www.inSE1.co.uk) and we shall soon be making back issues available online.

Bankside Press's range of services has continued to expand with the launch of the regular [SE1 Direct] email newsletters. To subscribe, send a blank email to [join@london-se1.co.uk](mailto:join@london-se1.co.uk)

**This Month**

**page 3**

**Exclusive:  
A ferry big  
disappointment  
for Bankside**

**page 8**

**Guide to half  
Term activities  
and events for  
children**

**in SE1**

www.London-SE1.co.uk

PO Box 16560  
London  
SE1 0YPTEL 020 7633 0766  
FAX 020 7620 4356

newsdesk@inSE1.co.uk

EDITOR Leigh Hatts  
THE TEAM James Hatts  
Francis James  
Marion Marples

© 2000 Bankside Press

PRINTED BY  
Copyprints Ltd,  
1 Talbot Yard, SE1 1YP**Advertising**For details of our  
competitive rates call  
for a rate card on 020  
7633 0766.**Subscriptions**To subscribe for 12  
issues please send a  
cheque for £5 to the  
address above, made  
payable to *in* SE1.**Listings**Details of events to be  
considered for inclusion  
in the June issue should  
be sent by 19 May 2000  
to the Listings Editor at  
the above address, or  
by fax or email.**Please note**Every effort is made to  
ensure accuracy but all  
details are subject to  
alteration – no  
responsibility can be  
accepted for any  
inaccuracies.**South Bank**Many other events take  
place each month at the  
South Bank Centre. Full  
details can be found in  
the Centre's own  
publications and at  
[www.sbc.org.uk](http://www.sbc.org.uk)**Next Month**

- Millennium Bridge
- Sam's Weekend @ Globe
- St Matthew's Fair
- Garden Squares Day
- Coin Street Festival
- Pharmacy History Day
- Photography @ IMAX
- Scott Walker's Meltdown
- Architecture Week

**Special Events & Festivals****Borough Market**

Southwark Street T 020 7407 1800

**Every Friday and Saturday  
BOROUGH FOOD MARKET**Fri 12 noon-6pm; Sat 9am-4pm; free  
Saturday 20 April will be the biggest event  
See the Borough Market website at  
[www.londonlarder.org.uk](http://www.londonlarder.org.uk) for full information.**Coin Street Festival**

South Bank T 020 7401 2255

**Monday 29 May****BBC MUSIC LIVE ON THE SOUTH BANK**12 noon-10pm; free  
The South Bank will be buzzing to the sound  
of music all the way from Jubilee Gardens to  
Oxo Tower Wharf. The event begins at  
midday with drumming down at the British  
Airways London Eye, and will culminate in the  
evening when the South Bank joins the rest of  
the country to sing along with *Perfect Day* at  
10pm. All genres of music will be represented  
along with street arts and workshops. Live  
broadcast on BBC1 at 2.30pm. BBC Music Live  
is a national 5-day celebration of music  
culminating in 24 hours of non-stop music on  
29 May. See [www.bbc.co.uk/musiclive](http://www.bbc.co.uk/musiclive)**Florence Nightingale Museum**St Thomas' Hospital T 020 7620 0374  
Mon-Fri 10am-5pm; Sat & Sun 11.30am-  
4.30pm; £4.80 (conc £3.60)**Monday 1 and Thursday 18 May  
WELCOME DAYS**Free admission to the museum as part of  
Museums and Galleries Month. Special  
guided tours will be available.**Every Friday in May  
FLORENCE NIGHTINGALE TOUR OF  
LONDON**10.30am; £10 (conc £8.50); booking essential  
Tour of the London residences of Florence  
Nightingale, the Crimean War Memorial and  
the museum. Call Helen Sellars at the  
museum to book your place.**Museum of the Royal Pharmaceutical  
Society of Great Britain**

1 Lambeth High Street T 020 7735 9141

**Every Thursday until 27 July  
SPECIAL MILLENNIUM OPENING**2.30pm; free  
Normally open by appointment only, there is  
a chance to visit this museum as part of the  
String of Pearls Millennium Festival, with  
special tours and demonstrations. Plus,  
subject to availability, enjoy the panoramic  
view of London from the rooftop terrace.**Royal National Theatre**

South Bank T 020 7452 3701

**Thursday 4 to Tuesday 30 May  
FOURTH WALL: TIME AFTER TIME ALONG  
THE RIVER**Mon-Sat 9.30pm (not 12, 19 or 26 May); free  
A specially commissioned film will be  
projected onto the concrete cube of the  
Lyttelton flytower. Marie José Burki's film is a  
portrait of people who live and work along the  
Thames. The soundtrack will be broadcast  
on Fourth Wall FM so that passers-by can  
experience the work. See [www.nt-online.org](http://www.nt-online.org)  
or call the information desk on the number  
above for details of related events.**Beyond SE1****RIBA Architecture Gallery**

66 Portland Place T 020 7580 5533

**Until Saturday 3 June****TATE TRANSFORMATION: BANKSIDE TO  
MODERN**Photographs by Richard Glover recording the  
project to transform the Bankside Power  
Station into Tate Modern – the first major  
public museum in London dedicated to  
showing solely international modern and  
contemporary art. Commissioned by the Tate,  
this work captures the immensity of this  
project but also highlights the subtle, graphic  
qualities of Herzog & de Meuron's architecture  
as it emerged during construction.**in SE1 Reader Offer***in* SE1 has teamed up with**LA SPEZIA**  
RESTAURANT

to offer

**15% off  
your total bill**for all *in* SE1 readers  
when dining in the month of MayPlease take this copy of *in* SE1  
with you and quote this offer  
when bookingNot to be used in conjunction with any  
other offer – for groups of 6 or less**LA SPEZIA**35 Railway Approach  
London Bridge  
SE1

Reservations 020 7407 0277

If your business or organisation is  
interested in a joint promotion with *in*  
SE1 call 020 7633 0766 or email  
[promotions@banksidepress.co.uk](mailto:promotions@banksidepress.co.uk)**Summer Writing at Morley College**One of London's best-known and respected Adult Education  
institutions, Morley College in Lambeth, is once again  
offering courses in creative writing in July, 2000.Morley is often associated with its music courses (Sir  
Michael Tippett, for example, taught there) and its excellent  
fine arts department and gallery. Perhaps less well-known  
are its courses in writing, both during term time and at  
weekends. The Summer courses, however, are different, in  
that they are both full-time and intensive.Why "Summer"? July in London can be hot and  
sometimes oppressive. People are beginning to escape to thecostas or the country cottage. For the serious-minded who  
choose to remain "in town", however, Morley offers a  
chance to begin, enhance or fine-tune talents in the great  
British art of writing, in a supportive and pleasant  
environment. One-to-one discussion and constructive  
criticism are a feature of these courses.All the courses are taught by published writers and  
visiting tutors will include several well-known authors.  
There are a few scholarship (financially supported) positions  
available. Spelling mistakes, such as Shakespeare made, are  
not considered important.**Summer Writing at Morley College**From Aristophanes to Iain Banks – From Sappho to Rose Tremain –  
the tradition of expressing ourselves through the printed word has tempted and  
tortured us! Morley can help!Morley College provides 3 levels of tuition in creative writing in July this year from those who are  
starting out to those who may already have been published. Our tutors are all published writers and  
dedicated teachers of their art and will be assisted by visiting novelists, poets and playwrights. Fees  
are moderate and some scholarship positions may be available.For further information or to enrol, contact Murray Rowlands or  
Julia Rollitt (020 7450 9235/6) or John Murphy (020 8208 0358)**What do you think about *in* SE1? E-mail [feedback@london-se1.co.uk](mailto:feedback@london-se1.co.uk)**

## Wellingtons Health Club

*If you would like to appear fitter, in better shape and more confident we can help you with our modern luxurious gym, beauty and treatment rooms*

**020 7401 8616**

101 Lower Marsh • SE1 7AB  
2 minutes from Waterloo Station

### We're ferry disappointed

Tate Modern may be opening with a fanfare this month, but the river service introduced last year will not be serving Bankside.

As we reported in our February issue, the Central London Fast Ferry – launched with a blaze of publicity in June 1999 – was withdrawn in December and replaced by a peak hours commuter service bypassing Bankside Pier. At the time Peter Lay of White Horse Fast Ferries told *in SE1* that he intended to reintroduce the full service at Easter once full infrastructure was in place.

In late April, with notices at Bankside Pier still advertising Christmas and New Year services, *in SE1* contacted White Horse. Mr Lay says that the company, which operates a service between Greenwich and the Dome, has "taken the decision that we are unable to start a full service [in Central London] until we have completed our commitment to the Millennium Experience."

This leaves Bankside without a river service during the first summer of Tate Modern, despite the Tate's website recommending the service to prospective visitors. The London River Services website, run by London Transport, also specifically mentions Bankside on its front page. But it is unlikely that the next scheduled service will call at the pier until 2001.

• [www.whitehorse.co.uk/ferries](http://www.whitehorse.co.uk/ferries)

### Dali Universe opens at County Hall

In the month that Londoners elect the first city-wide authority since the abolition of the Greater London Council, another new attraction opens at County Hall, joining the London Aquarium, Namco Station and FA Premier League Hall of Fame.

The 3000 square metre Dali Universe will feature over 500 works by the Spanish surrealist Salvador Dali, most of which have never before been exhibited in the UK. The range of artistic media employed by Dali is reflected in the three themed areas of the exhibition: *Sensuality and Femininity, Religion and Mythology and Dreams and Fantasy.*

Featuring major collections of his sculptures, rare graphics, jewellery, furniture and watercolours, the Dali Universe aims to provide Londoners and visitors alike with a Dali experience. The unique style is being presented in an atmospheric, surreal setting.

The complex will also feature a café and 80 seat auditorium. Visiting exhibitions of works by major artists will be held towards the end of the year.

- Dali Universe, County Hall, London SE1 7PB
- T 020 7620 2420
- [www.daliuniverse.com](http://www.daliuniverse.com)

### Book Review

#### Southwark Mysteries

The *Southwark Mysteries* cycle of mystery plays by John Constable, which received its world première at the Globe and Southwark Cathedral last month, is now available in book form (Oberon Books, £9.99). It is impossible to do justice to this remarkable work with so few words. The book is in two parts: *The Vision Books* contains poems and raps, whilst the second section contains the *Mystery* plays themselves. A glance at the list of players reveals the huge range of historical periods covered by the plays. There is also a comprehensive glossary, explaining references from the Clink to Costcutter and Jacob's Island to the Jubilee Line.

- See page 4 for details of performances this month.
- [mysteries.southwark.org.uk](http://mysteries.southwark.org.uk)

Specialist importers of wine and fine foods from south-west France.

### What does WWW mean?

[winewinewine.co.uk](http://winewinewine.co.uk)

#### WineWineWine

2 Bedale Street SE1 9AL  
020 7407 2724

### Bramah's

*A place to meet*

Butler's Wharf  
020 7378 0222

### SE1 Snippets

**LAMBETH INSPIRATION**  
Visitors to Lambeth Palace during the special millennium opening can see visual and written work by pupils at Johanna Primary School in Waterloo. The work was inspired by a school trip to the Palace. Visits by timed tickets continue until 4 November and booking is essential on 020 7898 1198.

• [www.stringofpearls.org.uk](http://www.stringofpearls.org.uk)

**HOSPITAL HOSPITALITY**  
As part of the String of Pearls Millennium Festival self-guided walking tours are now available at Guy's and St Thomas' Hospitals – ask for a leaflet at either reception. There will also be an open day on Friday 26 May at St Thomas' with music and entertainment celebrating the art and heritage of the hospital.

• [www.hospital.org.uk](http://www.hospital.org.uk)

**FOOD FINALISTS**  
Two SE1 restaurants are shortlisted in the *Time Out* Eating & Drinking Awards 2000. Tas in The Cut is a finalist in the Best Vegetarian Meal category, whilst Fish! in Borough Market is shortlisted for Best Interior Design. Full details of the shortlist are at [www.timeout.com](http://www.timeout.com). *Time Out's* Bankside guide is free with the magazine's 3 May issue.

**DOMES & WHEEL DEALS**  
If you can't face the British Airways London Eye telephone booking system, drop in to the Southwark Information Centre at London Bridge which now sells joint tickets for the Millennium Dome and the London Eye. Please note that this service is only available to personal callers, not over the phone.

• [sic.southwark.org.uk](http://sic.southwark.org.uk)

Get regular [SE1 Direct] email updates from *in SE1*

sign up to our mailing list at

[www.London-SE1.co.uk](http://www.London-SE1.co.uk)

### Daniel Cobb

LOCAL RESIDENTIAL SALES & LETTINGS AGENTS

Call us on 020 7357 0026 or visit

[www.danielcobb.co.uk](http://www.danielcobb.co.uk)

**Fax us with details of your event on 020 7620 4356**

## Theatre Focus

### Win dinner with an actor

Southwark Playhouse is holding a May Raffle to raise money for its forthcoming production of *The Winter's Tale*. Prizes include dinner for two with an actor, meals at Tas and 62 Restaurant, champagne, internet training, West End tickets and shopping vouchers. Bankside Attractions Group members including Vinopolis, Tate Modern and Shakespeare's Globe have also donated prizes. Tickets (£1 each or six for £5) can be purchased from the theatre and selected shops at Hay's Galleria and the Elephant & Castle. The raffle will be launched at the two shopping centres on 1 May and the draw takes place on 31 May.

## Shop Focus

### A taste of south-west France

Wine and wine in Borough Market is a surprise corner of SW France where the French paté and honey come cheaper than in the West End. It's run by well-known local resident Steve Harrison. He is the only supplier of a Bordeaux from a vineyard he knows well: Chateau Darmagnac is just £65 a case (it must increase in value) and the price includes storage and a chance to win a week's holiday at the vineyard during harvest time. Meanwhile paintings by Waterloo based artist Chris Owens are on show at the shop.

- Mon-Fri 9am-6pm
- 2 Bedale Street
- T 020 7407 2724
- www.wineandwine.co.uk

LEIGH HATTS

## Theatre

### The Old Vic

Waterloo Road/The Cut  
T 020 7369 1722

### Tuesday 9 May to Saturday 13 July

**DOLLY WEST'S KITCHEN**  
Mon-Sat 7.30pm, matinées Wed & Sat 3pm; £7.50-£30  
Play by Frank McGuinness, directed by Patrick Mason. Set in Donegal during the Second World War where Dolly West presides over the welcoming kitchen of a small house, a meeting place where two American GIs, a British army captain and the fiercely nationalistic West family share meals and talk of love, war and betrayal.

### Old Operating Theatre

9a St Thomas' Street  
T 020 7403 1496

### Tuesday 9 to Saturday 13 May

**THE ANATOMY CLASS**  
8pm; £8 (conc £6).  
A ritual healing of Southwark's physical and spiritual states, this performance invokes the ghosts of prostitutes and bodysnatchers, Thomas Becket, Mary Overie and Mary Magdalene.

### Royal National Theatre

South Bank  
T 020 7452 3000

### Until Saturday 6 May

**THE MYSTERIES**  
Cottesloe Theatre; from £12; phone for dates  
Revival of the National's famous 1980s production of this cycle of medieval plays

### Until Saturday 6 May

**THE ISLAND**  
Lyttelton Theatre; from £9; phone for dates  
Back by popular demand.

### Until Wednesday 10 May

**MERCHANT OF VENICE**  
Olivier Theatre; from £10; phone for dates  
Trevor Nunn's production.

### From Monday 15 May

**ALBERT SPEER**  
Lyttelton Theatre; from £9; phone for dates  
New play by David Edgar based on the biography by Gitta Sereny, directed by Trevor Nunn.

### From Thursday 25 May

**THE WAITING ROOM**  
Cottesloe Theatre; from £12; phone for dates  
A new play by Tanika Gupta, recently appointed the Pearson's Writer-in-residence at the National.

### Until Saturday 10 June

**THE VILLAINS' OPERA**  
Olivier Theatre; from £12; phone for dates  
Updated version of *The Beggar's Opera* by Nick Dear.

### Continuing in repertory

**BLUE/ORANGE**  
Cottesloe Theatre; from £12; phone for dates  
Joe Penhall's new play set in a London mental hospital.

### Shakespeare's Globe

21 New Globe Walk, Bankside  
T 020 7401 9919

### Monday 1 May

**THE WILLIAM POEL MEMORIAL FESTIVAL**  
4pm; £5  
Drama students perform scenes from plays by Shakespeare and his contemporaries.

### Friday 12 May to Sunday 10

**September THE TEMPEST**  
Call for dates & times; £5-£26  
Vanessa Redgrave plays Prospero.

### Sunday 28 May to Sunday 24

**September HAMLET**  
Call for dates & times; £5-£26  
With Mark Rylance as Hamlet.

### St John's Waterloo

Waterloo Road  
T 020 7366 9279

### Tuesday 23 May

**SOUTHWARK MYSTERIES**  
1.10-1.50pm  
A performance of poems from the Vision Books of the Southwark Mysteries with John Constable and the Liberty Crew.

### Southwark Playhouse

62 Southwark Bridge Road  
T 020 7620 3494

### Until Saturday 6 May

**THE GOOSE AT LIBERTY**  
Mon-Sat 8pm; £9 (conc £6)  
Poems, songs and ritual dramas from the Vision Books of the Southwark Mysteries. See Old Operating Theatre and Book Review on page 3.

## Our Cellar Restaurant & Wine Bar

47-49 Borough High Street  
London SE1

020 7407 3451

Open 11am-11pm  
5 days a week

Speciality: Italian food

### Tuesday 9 to Sunday 21 May

**ARTWORKS**  
7.30pm; £5  
Theatrical responses to the visual arts to celebrate the opening of Tate Modern. Includes *One* by Toby Farrow, inspired by the paintings of Edward Hopper, the first reading of *Gauguin* by Nick Pace and Graham McTavish and a video/audio performance by Julian Richards. Phone for programme details.

See Theatre Focus on this page.

### Union Theatre

204 Union Street  
T 020 7261 9876

### Tuesday 2 to Saturday 20 May

**MY HEART IN A SUITCASE**  
Tue-Sat 7.30pm; £8.50, concs £6.50  
Story of two identical sweaters, fear, money and the lack of it.

### The Young Vic

66 The Cut, Waterloo  
T 020 7928 6363

### Until Saturday 3 June

**MACBETH**  
Royal Shakespeare Company's revival of Macbeth starring Antony Sher and Harriet Walters.

www.young-vic.org

## Cinema

### BFI London IMAX Cinema

The Bullring, South Bank  
T 020 7902 1234

Programme from Monday 1 May  
**INTO THE DEEP (3D)**  
Mon-Fri 3.45pm; Sat & Sun 2.30pm & 7.30pm  
Dive into the magic of the ocean and swim with the sharks.

### MYSTERIES OF EGYPT

Mon-Fri 2.30pm; Sat & Sun 6.15pm  
Omar Sharif stars in this exploration of Egyptian myths.

### ENCOUNTER IN THE THIRD

**DIMENSION (3D)**  
Mon-Fri 12 noon, 6.15pm & 8.45pm; Sat & Sun 12 noon, 5pm & 8.45pm. Also Fri & Sat 10pm  
With thrilling 3D effects, the eccentric Professor and his robot sidekick take you on a magical journey.

### AFRICA: THE SERENGETI

Mon-Fri 1.15pm, 5pm & 7.30pm; Sat 11am, 1.15pm & 3.45pm; Sun 1.15pm & 3.45pm  
Experience the great migration of over 2 million wildebeest.

£6.75 (child £4.75; conc £5.75)  
Add-on feature £4

## CALL in the YARD

Most of the big and successful local firms do when they have something to say and they would like us to give a sharp edge to it.

PRINT  
COPIES  
REPORTS  
BROCHURES

Communication of all kinds

Copyprints Ltd  
BUSINESS  
CENTRE  
1 Talbot Yard  
SE1 1YP

Phone  
Fax

020 7407 2079  
020 7403 5411

Get in SE1 direct to your home or office - £5 a year - see back page

## Exhibitions

### Bankside Gallery

48 Hopton Street T 020 7928 7521  
Tue-Fri 10am-5pm (Tue 8pm) weekends 1-5pm;  
£3.50 (conc £2)

### Until Sunday 7 May PAMELA KAY RWS

The latest works of the still life artist.

### Friday 12 May to Sunday 11 June INDIAN EXCHANGE

Original prints by members of the Royal Society of Painter-Printmakers, plus works by Indian printmakers.

### Delfina

50 Bermondsey Street T 020 7357 6600  
Mon-Fri 10am-5pm; free

### Until Sunday 7 May MICHEL MAJERUS

A collision of visual media.

www.delfina.org.uk

### Delfina Project Space

51 Southwark Street T 020 7357 6600  
Mon-Fri 10am-5pm; free

### Thursday 4 to Sunday 28 May STEVE McQUEEN: COLD BREATH

First show at Delfina's new Bankside outpost.

### Design Museum

Shad Thames T 020 7378 6055  
Daily 11.30am (weekends 12 noon) -6pm; £5.25  
(conc £4)

### Until Sunday 4 June BAUHAUS DESSAU

An in-depth survey of the Bauhaus school from 1925 to 1932.

### Hayward Gallery

South Bank Centre T 020 7921 0971  
Daily 10am-6pm (Tue/Wed 8pm) £6 (conc £3.50)

### Until Sunday 18 June SONIC BOOM: THE ART OF SOUND

A whole new spin on sound in space. See page 8 for half term events for children.

### Imperial War Museum

Lambeth Road T 020 7416 5000  
Daily 10am-6pm; £5.20 (conc £4.20; children, senior citizens & after 4.30pm free)

### Until Sunday 7 May SIGNS OF THE TIMES: POSTERS IN CENTRAL EUROPE 1945-95

See www.idea.org.uk/posters

### Until Monday 29 May FROM THE BOMB TO THE BEATLES

Final chance to see the major exhibition on post-war Britain.

### Until Monday 27 November SPITFIRE SUMMER

Marking the 60th anniversary of the events of 1940.

### Jerwood Gallery

171 Union Street 020 7654 0171  
Mon-Sat 10am-6pm, Sun 12noon-6pm; free

### Until Sunday 4 June ...COMES THE SPIRIT

Ceramics, murals, posters, embroidery and more in an exhibition celebrating pleasure.

### Llewellyn Alexander Fine Paintings

The Cut T 020 7620 1322  
Mon-Sat 10am-7.30pm; free

### Until Saturday 6 May A MILLION BRUSHSTROKES VIII

Annual exhibition of over 900 miniatures by 120 artists.

### Wednesday 10 to Thursday 25 May TWO ARTIST SHOW

Oils of France, Italy and Scotland by Tessa Spenser Fryce and pastels of London by Terry McKivragan.

www.lafp.dircon.co.uk

### McHardy Sculpture Company

Shad Thames T 020 7403 7555  
Tue-Sat 11am-5pm, Sun 12noon-5pm; free

### Wednesday 10 to Wednesday 31 May EMOTION CAST IN BRONZE: LONI KREUDER

New sculpture.

www.mchardy-sculpture.com

### Morley Gallery

King Edward Walk T 020 7450 9226  
Mon-Fri 11am-6pm; late night Thu 7pm; Sat 12 noon-4pm; free

### Saturday 6 to Thursday 25 May THIRTEEN

Works by students and staff of Morley College.

www.morleycollege.ac.uk

### The Museum Of

Oxo Tower Wharf T 020 7401 2255  
Wed-Sun 12-6.30pm; free

### Until Sunday 4 June THE MUSEUM OF EMOTIONS

Explore your emotions from love to hate, and envy to fear.

### Museum of Garden History

Lambeth Palace Road T 020 7261 1891  
Sun-Fri 10.30-5pm; free (donations welcome)

### Sunday 14 May to Friday 2 June KAFFE FASSETT

See page 8 for lecture information.

www.museumgardenhistory.org

### Percy Miller Gallery

39 Snowsfields T 020 72074578  
Tue-Fri 11am-6pm; Sat 11am-3pm; free

### Until Saturday 10 June CAROLINE CHALMERS: ROACHES

Photographs of cockroaches.

www.art-online.org/percymiller

### Purdy Hicks Gallery

65 Hopton Street T 020 7401 9229  
Mon-Fri 10am-5.30pm (Wed 7pm); Sat & Sun 12 noon-5pm; free

### Friday 5 May to Sunday 4 June HUGHIE O'DONOGHUE: SMOKE SIGNALS

Large scale oil paintings inspired by World War II.

www.purdyhicks.com

### Royal Festival Hall Ballroom

South Bank Centre T 020 7960 4242  
Daily 10am-10.30pm; free

### Friday 19 May to Sunday 2 July DAVID WARD: CHORUS

Installation with 500 clear glass bubbles. Final Ballroom exhibition before Festival Hall refurbishment.

www.sbc.org.uk

### Royal National Theatre

South Bank T 020 7452 3000  
Mon-Sat 10am-11pm; free

### Monday 1 May to Saturday 3 June TIME AFTER TIME ALONG THE RIVER

Photos of the River Thames in London and the Hudson in New York. See page 2 for details of film projections.

### SE1 Gallery @ Workplace

64 Southwark Bridge Road  
T 020 7401 9494  
Mon-Fri 10am-5.30pm (Thu 7.30pm); free

### Until Friday 19 May ALL AROUND THE WORLD

Paintings by Vanda Harvey.

www.i-i.net/workplace

### Tate Modern

Bankside T 020 7887 8008  
Sun-Thu 10am-6pm (Fri & Sat 8pm); free

### Friday 12 May to October THE UNILEVER SERIES: LOUISE BOURGEOIS

A giant spider greets visitors in the Turbine Hall.

### Friday 12 May to December HERZOG & de MEURON AT BANKSIDE

Exhibition of the work of the architects responsible for the transformation of Bankside Power Station into Tate Modern.

www.tate.org.uk/modern

### the.gallery@oxo

Oxo Tower Wharf T 020 7401 2255  
Daily 11am-6pm; free

### Until Sunday 7 May OUR LONDON...OUR VOTE

How the Mayor & Assembly will change the way the city is run. A Coin Street Festival event.

### Friday 12 to Saturday 20 May PEUGEOT STUDENT AWARD

Design students' concepts applied to the automotive industry.

### Thursday 25 May to Tuesday 13 June BLADE OF LIGHT

Exhibition about the Millennium Bridge. A book published by Penguin accompanies the exhibition. See page 1 for details of this month's dedication of the bridge.

### Tom Blau Gallery

21 Queen Elizabeth Street T 020 7378 1300  
Mon-Fri 9am-6pm; free

### Monday 8 May to Friday 2 June AUTOPORTRAIT

Photographic portraits of Martin Parr collected whilst on assignment across the world. See www.martinparr.com

### The Walk Gallery

King Edward Walk  
T 020 928 3786  
Mon-Sat 11.30am-6pm (Thu 1.30-7pm); free

### Monday 15 May to Sunday 3 June THE URBAN LANDSCAPE

Photographic works by Jenny May and Hannah Mornement from London to Romania and Kosovo.

### Waterloo Action Centre

14 Baylis Road T 020 7261 0628

### Friday 5 to Thursday 25 May THE POSTHUMAN PROJECT

Mon-Wed, Sat 1pm-8pm, Thu & Fri 4pm-8pm  
Four contemporary artists react to an urban environment.

### The Vinopolis Gallery

1 Bank End T 0870 4444 777  
Tue-Fri 10am-5.30pm; Sat-Mon 10am-late;  
£11.50 (children £5)

### Until Sunday 11 June FRANZ GERTSCH: A MAJOR RETROSPECTIVE 1970-1995

Works by Swiss artist Franz Gertsch.

www.vinopolis.co.uk

## Exhibition Preview

### Elephant and Castle Families

Leigh Hirst was commissioned in 1994 by the Elephant & Castle Shopping Centre to take photographs of its customers. She placed a sofa in the mall, set up a light and spent two days recording a cross-section of the local community. Six years later, the photographer started to track down her subjects and asked them to write comments on their portraits. Of the 30 pictures in this exhibition, the identity of eight remains unknown.

- Leigh Hirst's photos can be seen at the Museum of London on London Wall from 17 May to 2 July.
- T 020 7600 0807
- www.museumoflondon.org.uk

## Eating & Drinking

### Food & drink at Tate Modern

Tate Modern's four food and drink outlets are sure to become very popular. On the ground floor the 240-seater Café 2 boasts a riverside terrace and will be open the same hours as the gallery. But for really great views Café 7 at the top of the building will be open daily for lunch. Evening meals will be available on Fridays and Saturdays. Half the tables can be booked in advance. Booking opens on 1 May. Also on Level 7 is the Café 7 bar, open daily from 10.30am. And for a quick coffee the Espresso bar is located on Level 4. All the outlets are directly managed by the Tate.

- T 020 7401 5020
- www.tate.org.uk/modern

JIM STONE

## Voluntary Viewpoint

### Arts Interest Group

The Arts Interest Group has been operating in the Wandsworth area for the past ten years, and has recently extended its activities into SE1, thanks to a grant from a local charity. AIG enables people with mobility problems with an interest in the visual arts to travel to and around London's major museums and art galleries. Members are picked up from home in a minibus and taken to the gallery where volunteers are on hand to offer assistance. There is a small charge for transport and members receive a reduced rate for admission fees. If you feel you would benefit from this scheme, or you would like to volunteer to help AIG (expenses paid), call Jane Turner on 020 8767 6244.

•artsinterest@tinyworld.co.uk  
JIM STONE

Find out about advertising with  
*in* SE1

Call  
**020 7633 0766**

or email  
sales@banksidepress.co.uk

**Bramah's**

*Good Morning Coffee*

**Butler's Wharf**  
020 7378 0222

## Music

**Cinema Organ Society London District**  
Edric Hall, South Bank University

**Sunday 21 May**  
**RUSSELL HOLMES**

3pm  
Recital on the university's Wurlitzer organ.

**St George's Cathedral**  
Westminster Bridge Rd T 020 7928 5256

**Thursday 25 May**  
**CHOIR OF NOTRE DAME UNIVERSITY, INDIANA, USA**  
7.30pm; £5 (conc £3)  
A repeat visit following on from the success of last year's spectacular concert. Proceeds in aid of CAFOD.

www.southwark-rc-cathedral.fsnet.co.uk

**St George the Martyr**  
Borough High Street T 020 7

**Every Thursday**  
**LUNCHTIME RECITALS**

1pm; free (donations welcome)  
Thu 4: **Pianofluté**  
Thu 11: **Sean Sion Pary** (violin)  
Thu 18: **Trevor Laver** (baritone)  
Thu 25: **Julia Raeburn**

**St John's Waterloo**  
Waterloo Road T 020 7366 9279

**Every Wednesday**  
**LUNCHTIME CONCERTS**  
1.10pm; donations welcome; refreshments  
Wed 3: **Milena Donova** (cello) & **Roxani Konstantinidou** (piano)  
Wed 10: **Geneviève Debry** (soprano)  
Wed 17: **Jessica Cox** (cello)  
Wed 24: **David Conway** (guitar)  
Wed 31: **Shu-Wei Tseng** (cello)

St John's Waterloo is on the web at  
www.stjohnswaterloo.ukf.net

Lunchtime Concert information is at  
move.to/livemusic

**St Matthew-at-the-Elephant**  
Meadow Row T 020 7357 8532

**Friday 12 May**  
**FRIDAY LUNCHTIME CONCERT**  
1.15pm; retiring collection  
King's College London student showcase. Lunches and light refreshments available.

**Morley College**  
61 Westminster Bridge Rd

**Tuesday 2 May**  
**LUNCHTIME CONCERT**  
1.10-1.55pm; free  
Rachael Covey (alto saxophone) with Joan Taylor (piano). Programme will include British première of *Music for Art & Tom* for alto sax and piano by Robert Keeley and music by Paul Creston, Amy Quate, Eugene Bozza, Ryo Noda and Claude Debussy.

**Southwark Cathedral**  
Montague Close T 020 7367 6700

**Every Monday**  
**ORGAN RECITAL**  
1.10pm; free (donations welcome)  
The recital on 15 May will be part of Peter Wright's *Bach 2000* series covering the complete organ works of JS Bach during 2000.

**Every Tuesday**  
**MUSIC RECITAL**  
1.10pm; free (donations welcome)  
Contact the cathedral for programme details.

**Saturday 13 May**  
**14th LONDON ORGAN CONCERT DAY**  
10am-3.30pm  
An educational day for organists - details from Susan Heath-Downey on 020 7231 1423. Supported by the Incorporated Association of Organists.

**Tuesday 23 May**  
**BACH IN HUNGARY**  
7pm; £7 (conc £5); tickets from 020 7936 3606  
Recital by John Scott from St Paul's Cathedral as part of the *From Bach to the Outer Limits* series organised by the Royal College of Organists.

## Church Services

**Christ Church Southwark**  
27 Blackfriars Road T 020 7928 4707

**Every Wednesday**  
**CELEBRATE**  
1.10pm

Informal weekly 40-minute lunchtime worship. Snack lunches are available at the church or you are welcome to bring your own food.

**St George's Cathedral**  
Lambeth Road T 020 7928 5256

**Thursday 4 May**  
**SOLEMN VESPERS**  
6pm

Commemoration of the 150th anniversary of the restoration of the Catholic Hierarchy of England and Wales, in the presence of the Catholic Bishops of England and Wales.

**St John's Waterloo**  
Waterloo Road T 020 7928 4470

**Sunday 14 May**  
**PARISH COMMUNION**  
10.30am

Sung by the Southwark Singers of London conducted by Denis Coleman. With professional storyteller Pat Bowen, who has been telling stories since she first discovered the revival in adult story telling in the late 1980s.

## Walks & Tours

**Shakespeare's Globe**  
New Globe Walk T 020 7401 9919

**Every Saturday from 13 May**  
**GLOBE WALKSHOPS**  
Meet 10am in the Globe Foyer; £6 (conc £5; students £4)  
Actor-led exploration of Bankside and its Shakespeare connections. Includes a short tour of the theatre.

**Stepping Out Tours**  
www.walklon.ndirect.co.uk  
T 020 8881 2933

**Every Sunday**  
**BROTHELS, BISHOPS AND THE BARD: HISTORIC SOUTHWARK AND BANKSIDE**  
Meet 11am at Monument station (Fish Street Hill exit); £5 (concs £3.50)  
Literature, religion and prostitution all feature in this exploration of one of London's most historic districts. Discover the Clink Prison, see the reconstructed Golden Hinde and Shakespeare's Globe and view Southwark Cathedral.

**London Walks**  
www.walks.com  
T 020 7624 3978

Call for full details of the walks programme.

## LONDON SE1

www.London-SE1.co.uk

The number one web guide to the South Bank is now two years old, and it's bigger and better than ever!

- Download *in* SE1 in Adobe Acrobat (PDF) format
- Daily events highlights on the front page
- Cast your vote in our opinion polls
- Share your views in the discussion forum
- Sign up for our weekly [SE1 Direct] mailings
- Buy theatre tickets from Ticketlinks and books from Amazon.co.uk

## Morley College

Nationally recognised as a provider of high quality education for adults

### Enjoy Summer in the City – Try Summer School

Try new things, have fun, meet new people, enjoy being in London in the summer.

Courses include acting, alternative health, art, ballet, bookbinding, brainpower, bridge, ceramics, clothes making, complementary therapy, creative writing, dance, exercise, film, first aid, food, history, interior design, jewellery, languages, literature, martial arts, massage, media, music, nutrition, philosophy, politics, printmaking, sculpture, textiles, video studies and yoga. Courses between 3 - 22 July, day & evening. Telephone or email for details.

Morley College, 61 Westminster Bridge Road, London SE1 7HT Tel 020 7928 8501 Fax: 020 7928 4074  
Email: enquiries@morleycollege.ac.uk Web: www.morleycollege.ac.uk



Call 020 7633 0766 for details of advertising opportunities

a bulletin from **FESTIVAL**  
**southwark**  
exclusive to in SE1

16 Winchester Walk London SE1 9AQ  
Tel 020 7403 7474 • Fax 020 7403 7493  
festival@southwarkfestival.org.uk

# Last call for Langenhagen and Expo 2000 visit

**There are still a few places left for the Business Exchange Visit to Langenhagen and Expo 2000.**

The visit, from Tuesday 13 to Monday 19 June, will continue to strengthen the Southwark link with its German twin, Langenhagen. It has also been timed to coincide with Expo 2000 and at least two days have been set aside to allow adequate time to explore the exhibition.

In addition delegates will be able to meet with business associates in Langenhagen and Hannover. Individual appointments will be organised to maximise the opportunities. As well as meetings and receptions, there will be free time to explore the Lower Saxony town.

Some 190 nations and international

organisations are due to be represented at Expo 2000 in Hannover making this a record-breaking World Exposition. The theme of this millennium Expo is *Humankind – Nature – Technology: a new world arising*, a 153-day global festival celebrating the achievements and aspirations of the participants at the dawn of the 21st century

The United Kingdom pavilion will be presenting our traditions and culture with subtle humour. An elaborate British multi media show is being called *No Man's An Island* —the title of a work by poet John Donne who knew Southwark.

The overall cost is £275 to include flight, airport tax and Expo 2000 entry. Accommodation is with host families. Call the Southwark Festival office on 020 7403 7474 to reserve a place.

## SOUTHWARK FESTIVAL 2000 Monday 16 October to Friday 3 November

### Lunchtime Concert Series

This favourite with so many local business people is taking shape and Peter Wright, director of music at Southwark Cathedral, will give the opening recital on Monday 16 October in the Cathedral. Peter is marking the 200th anniversary of the death of J S Bach by performing all of his organ works during the regular Monday lunchtime series. We are delighted that the Festival is part of this mammoth undertaking.

Another treat for organ aficionados is a workshop and recital by Colm Carey. Colm is organist at the chapel of St Peter-ad-Vincula in the Tower of London. On Thursday 19 October he will give an evening workshop in the chapel demonstrating the new organ and talking about his Cathedral lunchtime recital on Monday 23 October.

### Next Month

Full details of the Hay's Galleria evening concerts beginning on Tuesday 6 June and the Millennium Bridge Exhibition in Cottons Atrium.

# BANKSIDE TRADERS' ASSOCIATION *Update*

## BTA considers how Bankside businesses can benefit from central London status

**There was a packed board room for the first meeting of the new Bankside Traders' Association Committee featuring a brain storming session gathering ideas for exploiting Bankside's new status as part of central London.**

Ideas now being urgently explored include a members' discount scheme, a BTA presence at SE1 events and a business open day. Arrangements are also being made for a website.

Among the special events arranged is a viewing of the plans for the London Bridge Station redevelopment which will displace

the bus station. The impact on Borough High Street is being discussed with planners.

Meanwhile Committee members are due to attend an early morning meeting this month to discuss further initiatives to assist the growing number of small businesses on Bankside and in the Borough.

New members of Bankside Traders' Association include Utobeer who can be found in Borough Market on Fridays and Saturdays. Richard Dinwoodie heads the young company selling organic beers and other products – he discovered the Market when reading *in SE1*.

Also joining the BTA is Feng Sushi Ltd, which opens its second London shop on

Stoney Street in mid-June. They describe becoming a member as the first important decision on arriving in SE1. Feng Sushi will offer takeaway sushi, sashimi and a selection of tempura (vegetables deep fried in Japanese batter). Also on sale will be Japanese-style salads and tasty Japanese nips, a range of sushi plates, chopsticks, saki flasks and Japanese ceramics.

**Bankside Regeneration Tour**  
visit to the leading projects  
tour led by Chris Patterson  
Marketing & Inward Investment Officer, Southwark Council  
**Tuesday 23 May**  
1pm (approx 45 mins)  
Call 020 7403 7474 to reserve your place  
and for further information

*The Association works to represent the interests of traders and small businesses in the Bankside, Borough and London Bridge areas. Membership costs £40 per year. The Association management group meets regularly and organises a number of events during the year.*

For further details contact:  
Bankside Traders' Association, c/o Southwark Festival Association, 16 Winchester Walk, SE1 9AQ  
Tel: 020 7403 7474 • Email: festival@southwarkfestival.org.uk

**Join our email mailing list at [www.London-SE1.co.uk](http://www.London-SE1.co.uk)**

## This Month at a glance

A new one-stop guide

### May 2000 is...

...Museums & Galleries Month, a special millennium celebration incorporating Museums Week (May) and Gallery Week (June).

### First chance...

...to visit Tate Modern, and to sample the food and the views from the Tate Café on the seventh floor.

### Last chance...

...to catch the major post-war culture exhibition *From the Bomb to the Beatles* at the Imperial War Museum. See page 5.

### Don't miss...

...BBC Music Live on the South Bank, an all-day extravaganza on Bank Holiday Monday 29 May. See page 2.

### Find out...

...about the Waterloo Millennium Green project – check out the new website at [www.khi.co.uk/millenniumgreen](http://www.khi.co.uk/millenniumgreen)

### Stay tuned...

...to LBC 1152am, the official radio station of both Shakespeare's Globe and the HSBC Millennium Bridge Walk.

### And finally...

...let us know what you think of the refinements to *in SE1* this month. The address is on page 2, or email [comments@inSE1.co.uk](mailto:comments@inSE1.co.uk)

## in SE1

The deadline for listings and other contributions to our June 2000 issue is Friday 19 May

Contact details can now be found on page 2

### Bramah's

**Good Morning Coffee**

**Butler's Wharf**  
020 7378 0222

## Talks, Lectures & Meetings

### Florence Nightingale Museum

2 Lambeth Palace Road T 020 7620 0374

**Thursday 11 May**  
**FLORENCE NIGHTINGALE: MYSTIC, VISIONARY, HEALER**  
6.30pm; £10 (inc glass of wine and museum entry)

Lecture by Barbara Dossey in the McSwiney Lecture Theatre, St Thomas' Hospital. A Nurses Week event.

[www.florence-nightingale.co.uk](http://www.florence-nightingale.co.uk)

### Museum of Garden History: The Ark

Lambeth Palace Road T 020 7401 8865

**Friday 12 May**  
**MY TRAVELS AND PASSION FOR COLOUR**  
7pm; £15

Lecture by Kaffe Fassett, including private view of exhibition (page 5)

[www.museumgardenhistory.org](http://www.museumgardenhistory.org)

### Museum of the Royal Pharmaceutical Society of Great Britain

1 Lambeth High Street T 020 7735 9141

**Wednesday 17 May**  
**THE CHANGING IMAGE OF THE DOCTOR: A VIEW FROM THE CARTOONIST**  
7pm; free (booking essential)

Lecture by Professor Roy Port of the Wellcome Institute. Part of the String of Pearls Millennium Festival.

[www.rpsgb.org.uk](http://www.rpsgb.org.uk)

### Old Operating Theatre, Museum & Herb Garret

9a St Thomas' Street T 020 7955 4791

**Sunday 7 May**  
**KEATS AND THE POETRY AND SURGERY**  
2.30pm; £3.25 (conc £2.25; children £1.60)

Trained as an apothecary, John Keats studied surgery at Guy's Hospital. What effect did this have on his poetry?

### Southwark Cathedral

Montague Close T 020 7367 6700

**Tuesday 16 May**  
**CONNECTED ECONOMY – DISJOINTED SOCIETY**  
1pm; free

Annual lecture of the South London Industrial Mission (based at Christ Church in Blackfriars Road) given by Mark Goyder, Director of the Centre for Tomorrow's Company.

### Southwark & Lambeth Archaeological Society

Room 1, First Floor, Hawkstone Hall, Kennington Road

**Tuesday 23 May**  
**FOLLIES, GROTTOS AND GARDEN BUILDINGS**  
7.30pm (refreshments from 7pm); £1

Lecture by Ian Gray of the Folly Fellowship.

### Southwark Social Investment Forum

Clink Prison Museum, Clink Street 020 7207 0509

**Thursday 11 May**  
**MONTHLY MEETING**  
6-8pm; free

Exploring greater self-reliance in our community. Further details from Peter Challen on [peter@southwark.org.uk](mailto:peter@southwark.org.uk)

## THE CROWN & CUSHION

133 – 135 Westminster Bridge Road

Food served 7 days a week

Sunday lunch 12 till 5pm

Parties catered for

Function room available – no charge

Free disco available for large parties

Tel 020 7928 4795

Fax 020 7803 0573

## Events for Children

### Borough & Bankside Community Trust

Rainbow Centre, 32 Crosby Row T 020 7401 8190

**Every Friday until 2 June**  
**RIVER OF LANTERNS ART WORKSHOPS**  
5pm onwards; free

Young people over 11 (and parents) are invited to participate in the construction of a giant Aztec serpent for the River of Lanterns procession on 10 June to celebrate the opening of the Millennium Bridge. There is an opportunity to make masks and lanterns, play drums and dance.

See page 1 for more on the Millennium Bridge

### Hayward Gallery

South Bank Centre, Belvedere Road T 020 7960 4242

**Tuesday 30 May to Friday 2 June**  
**PLAYING WITH SOUND**

£5 (includes entrance to exhibition); booking essential on 020 7960 4242  
Produce your own CD with Sonic Arts Network artist-run workshops.  
Over 12s: Tuesday 30 & Wednesday 31 May; 2-4.30pm  
10-12 year olds: Thursday 1 June; 2-4.30pm  
7-10 year olds: Friday 2 June; 2-4.30pm

Plus each morning 10.30am-1pm there are Family drop-in practical workshops for all ages which parents are welcome to join in. £1 per person.

Activity sheets are available on request at all times.

[www.hayward-gallery.org.uk](http://www.hayward-gallery.org.uk)

### Imperial War Museum

Lambeth Road T 020 7416 5000

**Saturday 27 May to Sunday 4 June**  
**OPERATION DYNAMO: RESCUE FROM DUNKIRK**

12 noon, 12.30pm, 1pm, 2.30pm & 3pm; call 020 7416 5320 to book  
Actors in the role of returning servicemen will tell you about their experiences. Suitable for 7-13 year olds.

[www.iwm.org.uk](http://www.iwm.org.uk)

### Shakespeare's Globe

New Globe Walk T 020 7401 9919

**Saturday 20 May**  
**CHILD'S PLAY**

2-5.30pm; £9; event takes place in the Education Centre, Bear Gardens  
Active introduction for 8-11 year olds exploring Shakespeare's work through drama, storytelling and art. See page 4 for details of the 2000 Globe theatre season.

[www.shakespeares-globe.org](http://www.shakespeares-globe.org)

### Tower Bridge Experience

Tower Bridge T 020 7378 1928

**Saturday 27 May to Friday 2 June**  
**KITE-MAKING WORKSHOPS**

11am-4pm; workshops free on admission (£4.25 for children)  
Swoop down into Tower Bridge Experience for Kite-making Workshops that will blow you away! The workshops allow children (and parents) to make a specially designed Tower Bridge kite which they can then try out near the bridge's engine rooms.

[www.towerbridge.org.uk](http://www.towerbridge.org.uk)

## FOR OFFICE EQUIPMENT

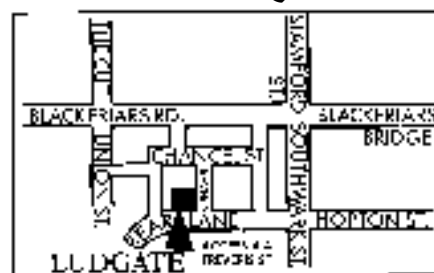

**LUDGATE OFFICE EQUIPMENT LIMITED**  
31 BEAR LANE LONDON SE1 0UH  
TEL: 020 7928 2871 FAX: 020 7620 2958